

**CITY OF BURNABY**

**BYLAW NO. 14033**

A BYLAW to amend Bylaw No. 4742, being Burnaby Zoning

Bylaw 1965, as amended by Bylaw Nos. 6406, 9629, 9863, 10431, 10677, 10869, 11765, 11775, 11869, 12494, and 13289 being Burnaby Zoning Bylaw 1965, Amendment Bylaw Nos. 45, 1973, 35, 1991, 12, 1993, 47, 1996, 60, 1997, 05, 1999, 47, 2004, 55, 2004, 04, 2005, 43, 2008, and 07, 2014

WHEREAS application for rezoning has been made to the Council;

AND WHEREAS the Council has held a public hearing thereon after duly giving notice of the time and place of such hearing as prescribed by Sections 466 and 467 of the *Local Government Act*, R.S.B.C. 2015;

NOW THEREFORE the Council of the City of Burnaby ENACTS as follows:

1. This Bylaw may be cited as **BURNABY ZONING BYLAW 1965, AMENDMENT BYLAW NO. 17, 2019.**

2. Bylaw No. 4742, as amended by Bylaw Nos. 6406, 9629, 9863, 10431, 10677, 10869, 11765, 11775, 11869, 12494, and 13289, is further amended as follows:

(a) The Map (hereinafter called "Map 'A'"), attached to and forming an integral part of Bylaw No. 4742, being "Burnaby Zoning Bylaw 1965", and designated as the Official Zoning Map of the City of Burnaby, is hereby amended according to the Map (hereinafter called "Map 'B'"), marginally numbered R.Z. 4176, annexed to this Bylaw, and in accordance with the explanatory legend, notations, references and boundaries designated, described, delimited and specified in

particularity shown upon said Map 'B'; and the various boundaries and districts shown upon said Map 'B' respectively are an amendment of and in addition to the respective districts, designated and marked on said Map 'A' insofar as the same are changed, modified or varied thereby, and the said Map 'A' shall be deemed to be and is hereby declared to be amended accordingly and the said Map 'B' is hereby declared to be and shall form an integral part of said Map 'A', as if originally incorporated therein and shall be interpreted accordingly.

(b) The Comprehensive Development Plans more particularly described in Bylaw Nos. 6406, 9629, 9863, 10431, 10677, 10869, 11765, 11775, 11869, 12494, and 13289 are amended in accordance with the adopted Development Plan entitled "Grand Villa Casino, Burnaby Slot & Gaming Floor Increase" prepared by MGB Architecture Inc. and on file in the office of the Director Planning and Building; and any development on the lands rezoned by this Bylaw shall be in conformity with the said Comprehensive Development Plans as amended.

Read a first time this 10<sup>th</sup> day of June 2019

Read a second time this 8<sup>th</sup> day of July 2019

Read a third time this 29<sup>th</sup> day of July 2019

Reconsidered and adopted this 16<sup>th</sup> day of September 2019

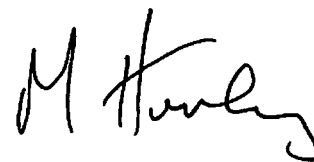

MAYOR

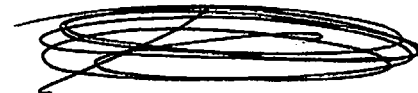

CLERK

BYLAW NUMBER 14033 BEING A BYLAW TO AMEND BYLAW  
NUMBER 4742 BEING BURNABY ZONING BYLAW 1965

**REZ.19-08**

LEGAL: Lot A Except: Firstly; the East 569.25 Feet, Secondly; Portions in Plan LMP32853, Thirdly; Part in Plan BCP21070, DL 70, Group 1, NWD Plan 9892; Lot 1, DL 70, Group 1, NWD Plan BCP21069; Lot 51, Except Part in Plan BCP21070, DL 70, Group 1, NWD Plan 62993

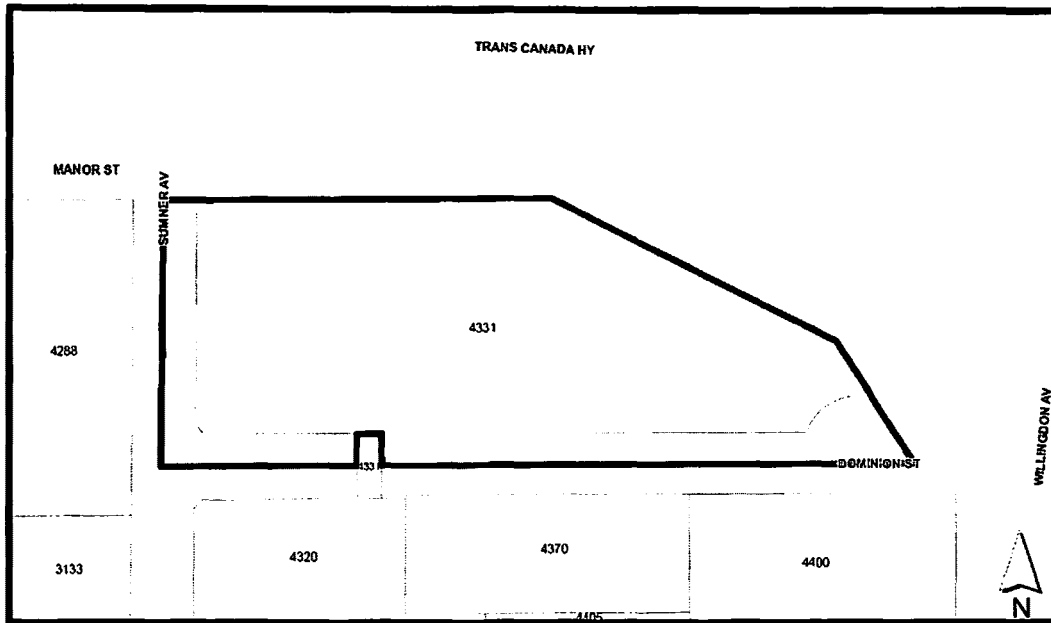

THE AREA(S) SHOWN ABOVE OUTLINED IN BLACK (——) IS (ARE) REZONED

FROM: CD Comprehensive Development District (based on C3, C3d, C3f General Commercial District, P8 Parking District and B2 Urban Office District)

TO: Amended CD Comprehensive Development District (based on C3, C3d, C3f General Commercial District, P8 Parking District and B2 Urban Office District, and in accordance with the development plan entitled "Grand Villa Casino, Burnaby Slot & Gaming Floor Increase" prepared by MGB Architecture Inc.)

	PLANNING AND BUILDING DEPARTMENT	
	<b>OFFICIAL ZONING MAP</b>	Map "B" No. REZ. 4176
		Date: MAY 28 2019
		scale: 1:2,000
Drawn By: AY		