

CITY OF BURNABY

BYLAW NO. 13930

A **BYLAW** to close and remove the dedication of
a certain portion of highway

WHEREAS pursuant to section 40 of the *Community Charter* and section 120 of the *Land Title Act* the Council may by bylaw close part of a highway to traffic and remove the dedication of that part of the highway;

AND WHEREAS the Council, before adopting this Bylaw, has caused the required statutory public notice of its intention to be given by advertisement;

AND WHEREAS the Council deems it expedient and in the public interest to stop up and close to traffic and remove the dedication of that portion of highway more particularly hereinafter described;

NOW THEREFORE the Council of the City of Burnaby ENACTS as follows:

1. This Bylaw may be cited as **BURNABY HIGHWAY CLOSURE BYLAW NO. 5, 2018.**

2. ALL AND SINGULAR that certain parcel or tract of land, situate, lying and being in the City of Burnaby, in the Province of British Columbia, more particularly known and described as all that portion of lane in District Lots 151 and 153, Group 1, New Westminster District, dedicated by Plan 2884, containing 386.3m² (hereinafter called "the closed portion of lane") shown outlined on Reference Plan prepared by Mike E. Shaw, B.C.L.S., and certified in the Land Title Office under Number EPP81695, a copy of which is hereunto annexed is hereby closed to all types of traffic.

3. The dedication of the closed portion of lane as highway is removed.

Read a first time this 27th day of August 2018

Read a second time this 27th day of August 2018

Read a third time this 27th day of August 2018

Reconsidered and adopted this 17th day of September 2018

MAYOR



CLERK

REFERENCE PLAN TO ACCOMPANY THE CITY OF BURNABY ROAD CLOSING AND REMOVAL OF ROAD DEDICATION BYLAW No. 13930 - BURNABY HIGHWAY CLOSURE BYLAW No. 5, 2018: OF A PORTION OF LANE DEDICATED BY PLAN 2884, DISTRICT LOTS 151 AND 153, GROUP 1, NEW WESTMINSTER DISTRICT

PLAN EPP81695

PURSUANT TO SECTION 120, L.T.A. AND SECTION 40, COMMUNITY CHARTER B.C.G.S. 92C.026

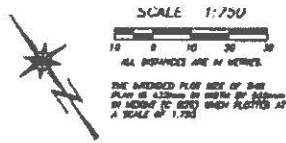

INTEGRATED SURVEY AREA No. 25
(BURNABY) NAD 83
(CSRS) 4.0.0 BC LGVRO
LITM ZONE 1D

THE UTM COORDINATES AND ESTIMATED HORIZONTAL POSITIONAL ACCURACY ACHIEVED HAVE BEEN OBTAINED FROM THE MOST RECENT COORDINATE AND CONTROL SURVEYS FOR GEODETIC CONTROL MONUMENTS (SPLS) AND (SPS) (SPLS) THIS PLAN SHOWS HORIZONTAL CONTROL-LEVEL REDUNDANT (SPLS) STATIONS REFERRED TO CONTROL AND DISTANCES, MULTI-LEVEL-LEVEL REDUNDANT BY THE ADJUTANT CHIEF SURVEYOR OF A REGION WHICH HAS BEEN DERIVED FROM GEODETIC CONTROL MONUMENTS (SPLS)

LEGEND

- GPS STATIONS ARE DERIVED FROM COORDINATES WITHIN GEODETIC CONTROL MONUMENTS (SPLS) AND (SPS) (SPLS)
- - SHOWS CONTROL MONUMENT FOUND
 - - SHOWS STATIONING SIGN POST FOUND
 - - SHOWS LEAD PLUG FOUND
 - - SHOWS STATIONING SIGN POST PLACED
 - - SHOWS LEAD PLUG PLACED
 - - SHOWS OBSERVED
 - MI - SHOWS NO RECORD
- ▬ - SHOWS PORTION OF ROAD TO BE CLOSED

THIS PLAN SHOWS ONE OR MORE STATIONING POSTS WHICH ARE NOT SET ON THE TRUE CORNERS AND ARE SET ALONG THE PRODUCTION OF THE PROPERTY BOUNDARY (UNLESS OTHERWISE NOTED)

BOOK OF REFERENCE (LANE TO BE CLOSED)	
DESCRIPTION	AREA
LANE, PLAN 2884	306.3 m ²

BYLAW 13930 (CSRS) - SUBJECT OVERLAP ZONE 1D					
CONTRIBUTOR	DESCRIPTION	EASING	ESTIMATED HORIZONTAL ACCURACY	COORDINATE FACTOR	
8701251	8422+28.552	48441.923	±0.01	0.9999819	
8701252	8422+28.552	48441.923	±0.01	0.9999819	

NOTE: FOR MAPPING PURPOSES ONLY

THE FIELD SURVEY REPRESENTED BY THIS PLAN WAS COMPLETED ON THE 11th DAY OF FEBRUARY, 2014 BY S.L. SMITH, S.L.S. 2011

PROPERTY LAND SURVEYING LTD.
P.O. BOX 1000
1000-1177 STREET
BURNABY, B.C. V5H 2P4
PHONE: 604-582-0717

BYLAW # 13930-0-01
FILE # J1010-0-01
DATE: AUGUST 31, 2018

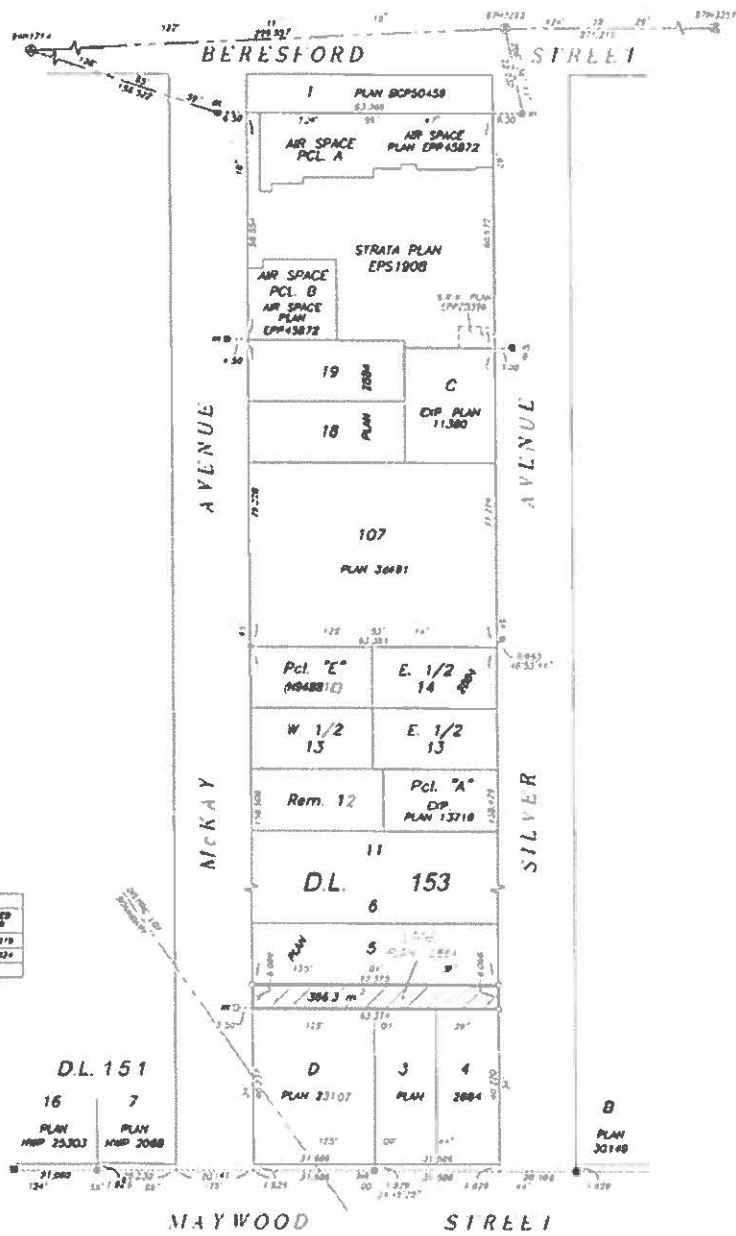

THIS PLAN LIES WITHIN THE METRO VANCOUVER REGIONAL DISTRICT