

CITY OF BURNABY

BYLAW NO. 13899

A BYLAW to amend Bylaw No. 4742, being
Burnaby Zoning Bylaw 1965

WHEREAS application for rezoning has been made to the Council;

AND WHEREAS the Council has held a public hearing thereon after duly giving notice of the time and place of such hearing as prescribed by Sections 466 and 467 of the *Local Government Act*, R.S.B.C. 2015;

NOW THEREFORE the Council of the City of Burnaby ENACTS as follows:

1. This Bylaw may be cited as **BURNABY ZONING BYLAW 1965, AMENDMENT BYLAW NO. 20, 2018.**
2. The Map (hereinafter called "Map 'A'"), attached to and forming an integral part of Bylaw No. 4742, being "Burnaby Zoning Bylaw 1965", and designated as the Official Zoning Map of the City of Burnaby, is hereby amended according to the Map (hereinafter called "Map 'B'"), marginally numbered REZ. 4137 annexed to this Bylaw, and in accordance with the explanatory legend, notations, references and boundaries designated, described, delimited and specified in particularity shown upon said Map 'B'; and the various boundaries and districts shown upon said Map 'B' respectively are an amendment of and in substitution for the respective districts, designated and marked on said Map 'A' insofar as the same are changed, modified or varied thereby, and the said Map 'A' shall be deemed to be and is hereby declared to be amended accordingly and the said Map 'B' is hereby declared to be and shall form an integral part of said Map 'A', as if originally incorporated therein and shall be interpreted accordingly.

3. The Comprehensive Development Plan entitled "2421 ALPHA", prepared by SHIFT ARCHITECTURE INC. and on file in the office of the Director Planning and Building, is deemed to be attached to and form part of this Bylaw and any development on the lands rezoned by this Bylaw shall be in conformity with the said Comprehensive Development Plan.

Read a first time this 11th day of June, 2018

Read a second time this 9th day of July, 2018

Read a third time this 30th day of March, 2020

Reconsidered and adopted by Council this 14th day of December, 2020



MAYOR

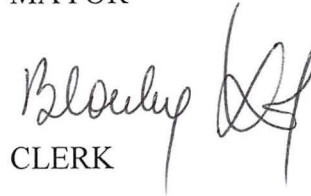

CLERK

**BYLAW NUMBER 13899 BEING A BYLAW TO AMEND BYLAW
NUMBER 4742 BEING BURNABY ZONING BYLAW 1965**

REZ.17-13

LEGAL: Lot 26 Except: Parcel A (Reference Plan 32814), DL 124, Group 1, NWD Plan 3343

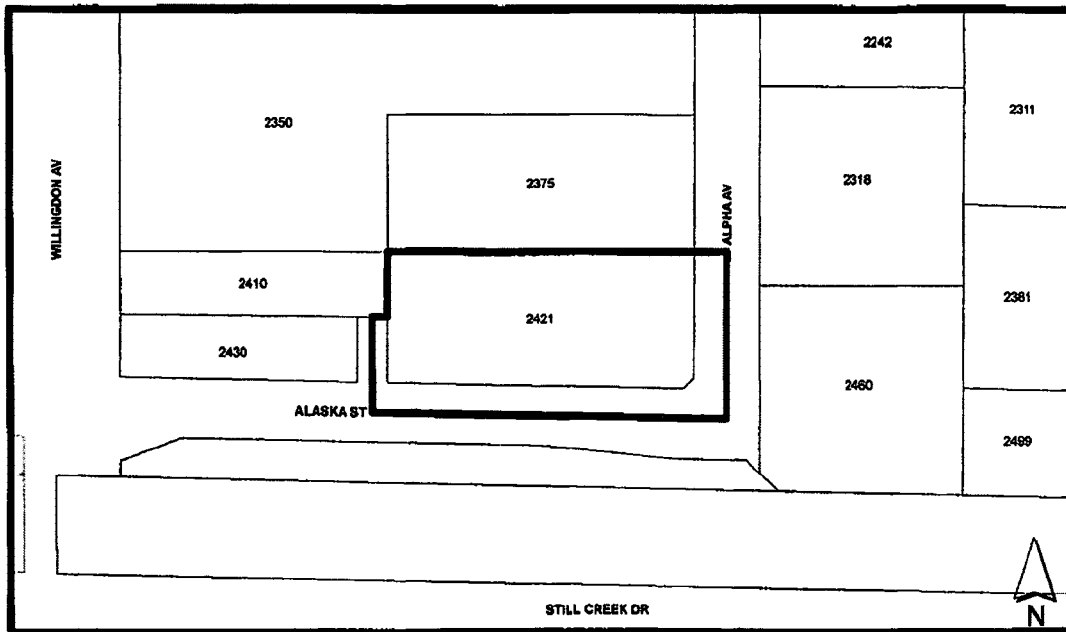

THE AREA(S) SHOWN ABOVE OUTLINED IN BLACK (——) IS (ARE) REZONED

FROM: M1 Manufacturing District

TO: CD Comprehensive Development District (based on RM4s Multiple Family Residential District, C2 Community Commercial District and Brentwood Town Centre Development Plan as guidelines and in accordance with the development plan entitled "2421 Alpha" prepared by Shift Architecture Inc.)

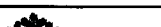
	PLANNING AND BUILDING DEPARTMENT	
	OFFICIAL ZONING MAP	Map "B" No. REZ. 4137
Date: MAY 17 2018		
scale: 1:1,844		
Drawn By: AY		