

CITY OF BURNABY

BYLAW NO. 13862

A BYLAW to amend Bylaw No. 4742, being Burnaby Zoning

Bylaw 1965, as amended by Bylaw No. 6100, being Burnaby Zoning
Bylaw 1965, Amendment Bylaw No. 33, 1972

WHEREAS application for rezoning has been made to the Council;

AND WHEREAS the Council has held a public hearing thereon after duly giving notice of the hearing as prescribed by sections 466 and 467 of the *Local Government Act*, R.S.B.C. 2015;

NOW THEREFORE the Council of the City of Burnaby ENACTS as follows:

1. This Bylaw may be cited as **BURNABY ZONING BYLAW 1965, AMENDMENT BYLAW NO. 10, 2018.**
2. The map (hereinafter called "Map 'A'") attached to and forming an integral part of Bylaw No. 4742, being Burnaby Zoning Bylaw 1965, and designated as the Official Zoning Map of the City of Burnaby, is hereby amended according to the Map (hereinafter called "Map 'B'"), marginally numbered REZ. 4128, annexed to this Bylaw, and in accordance with the explanatory legend, notations, references and boundaries designated, described, delimited and specified in particularity shown upon said Map 'B', and the various boundaries and districts shown upon said Map 'B', respectively are an amendment of and in substitution for the respective districts, designated and marked on said Map 'A' insofar as the same are changed, modified or varied thereby, and the said

Map 'A' shall be deemed to be and is hereby declared to be amended accordingly and the said Map 'B' is hereby declared to be and shall form an integral part of said Map 'A' as if originally incorporated therein and shall be interpreted accordingly.

Read a first time this 9th day of April 2018

Read a second time this 7th day of May 2018

Read a third time this 14th day of May 2018

Reconsidered and adopted this 14th day of May 2018



MAYOR

CLERK

BYLAW NUMBER 13862 BEING A BYLAW TO AMEND BYLAW NUMBER 4742 BEING BURNABY ZONING BYLAW 1965

REZ.17-29

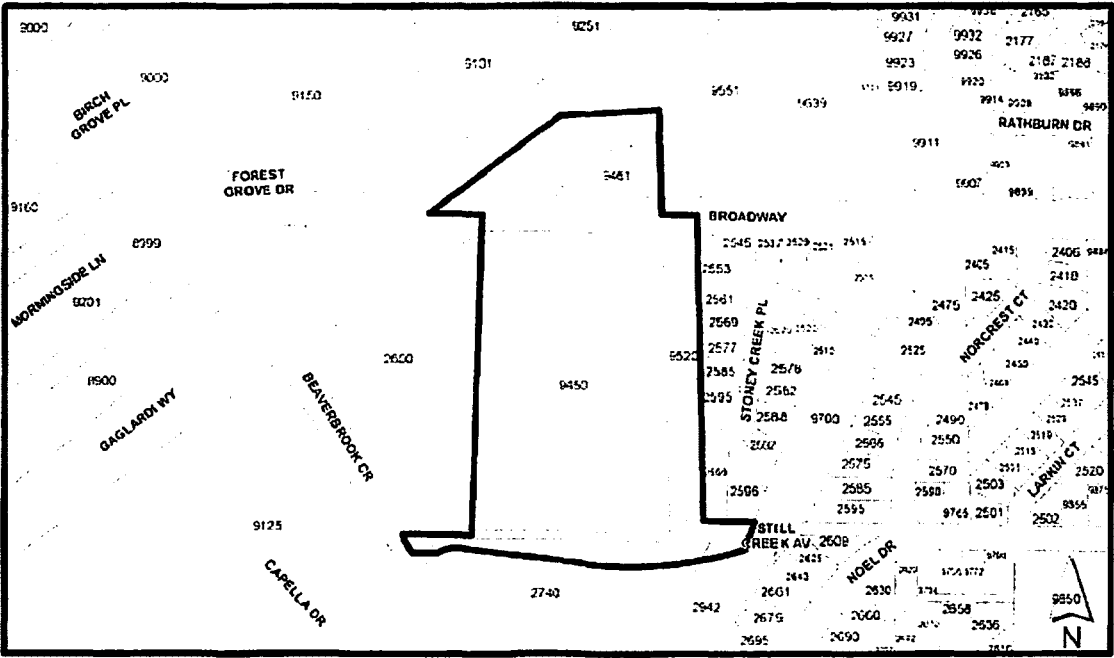
LEGAL: See attached Schedule A



THE AREA(S) SHOWN ABOVE OUTLINED IN BLACK (——) IS (ARE) REZONED

FROM: R2 Residential District

TO: M2 General Industrial District, P3 Park and Public Use District and P12 Utility Corridor District

	PLANNING AND BUILDING DEPARTMENT	
Date: MAR 28 2018	OFFICIAL ZONING MAP	
scale: 1:5,000		
Drawn By: AY		

**SCHEDULE A
REZONING #17-29**

Address	Zone from:	Zone to:	Legal Description
BC Hydro and Power Authority Owned Lands			
9450 Broadway	R2	M2	South West Quarter District Lot 15 Group 1 Except: Firstly: East 264 Feet Secondly: Part Subdivided By Plan 49579 Thirdly: Part Subdivided By Plan 51478 Fourthly: Part Subdivided By Plan 83735 Fifthly: 2.213 Acres Statutory Right Of Way Plan 31706 New Westminster District
9369 Broadway	R2	P12	Lot 3, Except: Firstly: Part On Reference Plan 2411, Secondly: Part Subdivided By Plan 51478 And Thirdly: Part Road On Plan Lmp24005, Fourthly: Part Road On Statutory Right Of Way Plan 49347, District Lot 15 Group 1 New Westminster District Plan 209
9461 Broadway	R2	P12	Lot 4, Except: Firstly: Part On Reference Plan 2411; Secondly: Part Subdivided By Plan 51478, Thirdly: Part On Statutory Right Of Way Plan 62130, Fourthly: Part Road On Plan Lmp24005 And Fifthly: Part On Statutory Right Of Way Plan 49247, District Lot 15 Group 1 New Westminster District Plan 209
9520 Broadway	R2	P12	Lot 1 District Lot 15 Group 1 New Westminster District Plan 17870
Burnaby School District Owned Lands			
Portion of 2740 Beaverbrook Crescent	R2	P3	Lot 309 Of District Lots 8 And 56 Group 1 New Westminster District Plan 57113