

CITY OF BURNABY

BYLAW NO. 13630

A BYLAW to amend Bylaw No. 4742, being Burnaby Zoning Bylaw 1965, as amended by Bylaw No. 11414, being Burnaby Zoning Bylaw 1965, Amendment Bylaw No. 28, 2002

WHEREAS application for rezoning has been made to the Council;

AND WHEREAS the Council has held a public hearing thereon after duly giving notice of the hearing as prescribed by sections 466 and 467 of the *Local Government Act*, R.S.B.C. 2015;

NOW THEREFORE the Council of the City of Burnaby ENACTS as follows:

1. This Bylaw may be cited as **BURNABY ZONING BYLAW 1965, AMENDMENT BYLAW NO. 29, 2016.**
2. Bylaw No. 4742, as amended by Bylaw No. 11414, is further amended as follows:
 - (a) The Map (hereinafter called "Map 'A'"), attached to and forming an integral part of Bylaw No. 4742, being "Burnaby Zoning Bylaw 1965", and designated as the Official Zoning Map of the City of Burnaby, is hereby amended according to the Map (hereinafter called "Map 'B'"), marginally numbered REZ. 4054 annexed to this Bylaw, and in accordance with the explanatory legend, notations, references and boundaries designated, described, delimited and specified in particularity shown upon said Map 'B', and the various boundaries and districts shown upon said Map 'B', respectively are an amendment of and in substitution for

the respective districts, designated and marked on said Map 'A' insofar as the same are changed, modified or varied thereby, and the said Map 'A' shall be deemed to be and is hereby declared to be amended accordingly and the said Map 'B' is hereby declared to be and shall form an integral part of said Map 'A' as if originally incorporated therein and shall be interpreted accordingly.

Read a first time this 25th day of July 2016
Read a second time this 12th day of September 2016
Read a third time this 23rd day of July 2018
Reconsidered and adopted this 23rd day of July 2018



MAYOR

CLERK

BYLAW NUMBER 13630 BEING A BYLAW TO AMEND BYLAW NUMBER 4742 BEING BURNABY ZONING BYLAW 1965

REZ.16-03

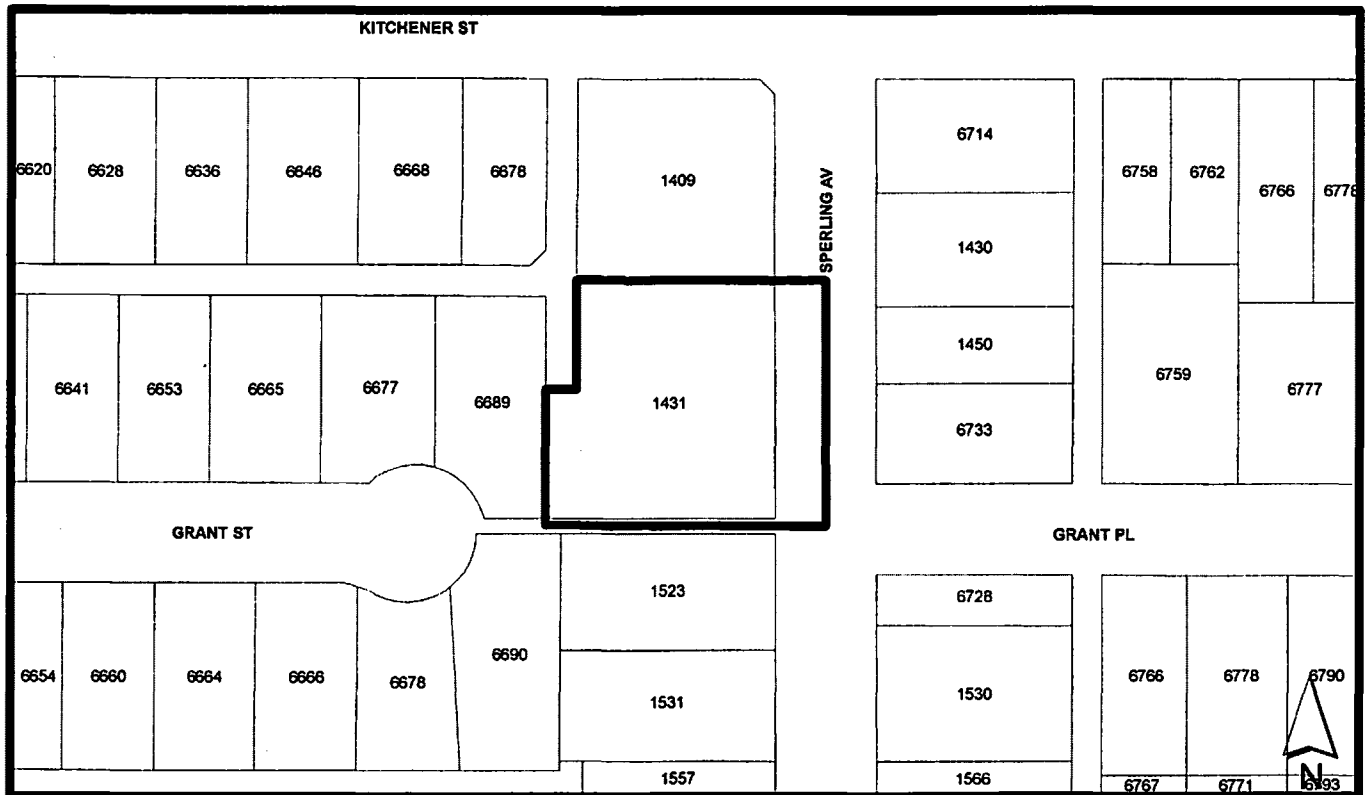
LEGAL: Lot 351, DL 132, Group 1, NWD Plan 53646



THE AREA(S) SHOWN ABOVE OUTLINED IN BLACK (——) IS (ARE) REZONED

FROM: CD Comprehensive Development District (based on C1 Neighbourhood Commercial District and P1 Neighbourhood Institutional District)

TO: R4 Residential District

	PLANNING AND BUILDING DEPARTMENT	
	OFFICIAL ZONING MAP	Map "B" No. REZ. 4054
		Date: JUL 07 2016 scale: 1:1,500 Drawn By: AY