

CITY OF BURNABY

BYLAW NO. 13578

A BYLAW to amend Bylaw No. 4742, being Burnaby Zoning Bylaw 1965, as amended by Bylaw Nos. 8730, 10432, 11370, 12084, and 13026 being Burnaby Zoning Bylaw 1965, Amendment Bylaw No., 24, 1987, No. 48, 1996, No. 12, 2002, No. 16, 2006 and No. 48, 2011

WHEREAS application for rezoning has been made to the Council;

AND WHEREAS the Council has held a public hearing thereon after duly giving notice of the time and place of such hearing as prescribed by Sections 466 and 467 of the *Local Government Act*, R.S.B.C. 2015;

NOW THEREFORE the Council of the City of Burnaby ENACTS as follows:

1. This Bylaw may be cited as **BURNABY ZONING BYLAW 1965, AMENDMENT BYLAW NO. 6, 2016.**

2. Bylaw No. 4742, as amended by Bylaw Nos. 8730, 10432, 11370, 12084, and 13026, is further amended as follows:

(a) The Map (hereinafter called "Map 'A'"), attached to and forming an integral part of Bylaw No. 4742, being "Burnaby Zoning Bylaw 1965", and designated as the Official Zoning Map of the City of Burnaby, is hereby amended according to the Map (hereinafter called "Map 'B'"), marginally numbered R.Z. 4031, annexed to this Bylaw, and in accordance with the explanatory legend, notations, references and boundaries designated, described, delimited and specified in particularity shown upon said Map 'B'; and the various boundaries and districts shown upon said

Map 'B' respectively are an amendment of and in addition to the respective districts, designated and marked on said Map 'A' insofar as the same are changed, modified or varied thereby, and the said Map 'A' shall be deemed to be and is hereby declared to be amended accordingly and the said Map 'B' is hereby declared to be and shall form an integral part of said Map 'A', as if originally incorporated therein and shall be interpreted accordingly.

(b) The Comprehensive Development Plan more particularly described in Bylaw Nos. 8730, 10432, 11370, 12084, and 13026 is amended in accordance with the adopted Development Plan entitled "REZONING APPLICATION FOR BRIDGE STUDIOS" prepared by CTA DESIGN GROUP and on file in the office of the Director Planning and Building; and any development on the lands rezoned by this Bylaw shall be in conformity with the said Comprehensive Development Plan as amended.

Read a first time this 7th day of March 2016

Read a second time this 4th day of April 2016

Read a third time this 26th day of June 2017

Reconsidered and adopted this 24th day of July 2017



MAYOR

CLERK

BYLAW NUMBER 13578 BEING A BYLAW TO AMEND BYLAW NUMBER 4742 BEING BURNABY ZONING BYLAW 1965

REZ.15-35

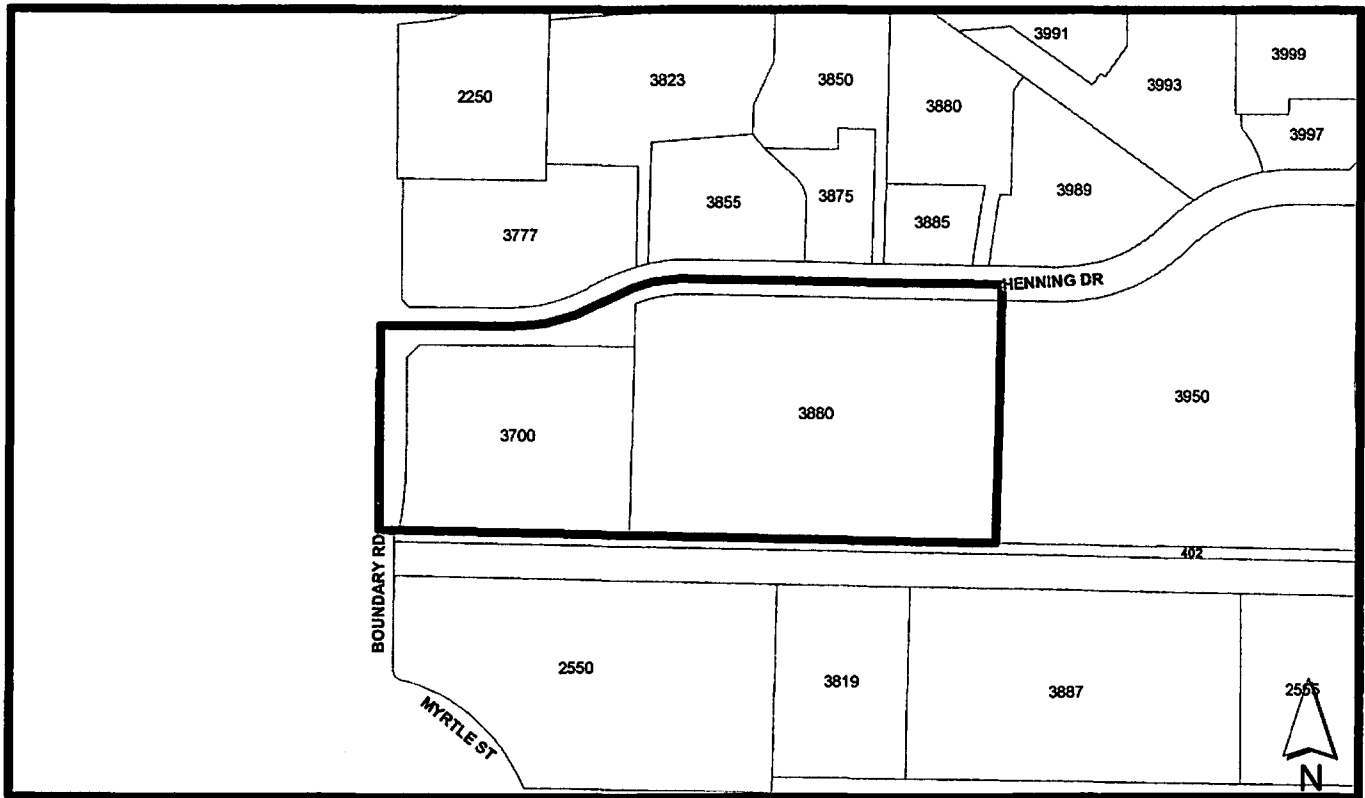
LEGAL: Lot 3, DL 118, Group 1, NWD Plan 76093 Except Plans LMP30514 & BCP51462; Lot 2 Except: Part Dedicated Road On Plan LMP2986, DL 118, Group 1, NWD Plan 76093



THE AREA(S) SHOWN ABOVE OUTLINED IN BLACK (——) IS (ARE) REZONED

FROM: CD Comprehensive Development District (based on the M1 Manufacturing District and M5 Light Industrial District)

TO: Amended CD Comprehensive Development District (based on M1 Manufacturing District and M5 Light Industrial District and the development plan entitled "Rezoning Application for Bridge Studios" prepared by CTA Design Group)

	PLANNING AND BUILDING DEPARTMENT	
	OFFICIAL ZONING MAP	Map "B" No. REZ. 4031
	Date: JAN 11 2016 scale: 1:5,000 Drawn By: AY	