

CITY OF BURNABY

BYLAW NO. 13465

A BYLAW to amend Bylaw No. 4742, being Burnaby Zoning Bylaw 1965, as amended by Bylaw Nos. 6631, 11004, and 13247 being Burnaby Zoning Bylaw 1965, Amendment Bylaw Nos., 24, 1973, 46, 1999, and 31, 2013

WHEREAS application for rezoning has been made to the Council;

AND WHEREAS the Council has held a public hearing thereon after duly giving notice of the time and place of such hearing as prescribed by Sections 892 and 893 of the *Local Government Act*, R.S.B.C. 1996;

NOW THEREFORE the Council of the City of Burnaby ENACTS as follows:

1. This Bylaw may be cited as **BURNABY ZONING BYLAW 1965, AMENDMENT BYLAW NO. 13, 2015.**

2. Bylaw No. 4742, as amended by Bylaw Nos. 6631, 11004, and 13247, is further amended as follows:

(a) The Map (hereinafter called "Map 'A'"), attached to and forming an integral part of Bylaw No. 4742, being "Burnaby Zoning Bylaw 1965", and designated as the Official Zoning Map of the City of Burnaby, is hereby amended according to the Map (hereinafter called "Map 'B'"), marginally numbered R.Z. 4002, annexed to this Bylaw, and in accordance with the explanatory legend, notations, references and boundaries designated, described, delimited and specified in particularity shown upon said Map 'B'; and the various boundaries and districts shown upon said Map 'B' respectively are an amendment of and in addition to the respective districts, designated and marked on said Map 'A' insofar as the same are changed, modified or varied thereby, and the said Map 'A' shall be deemed to be and is hereby declared to be amended accordingly and the said Map

'B' is hereby declared to be and shall form an integral part of said Map 'A', as if originally incorporated therein and shall be interpreted accordingly.

(b) The Comprehensive Development Plan more particularly described in Bylaw Nos. 6331, 11004, and 13247 is amended in accordance with the adopted Development Plan entitled "CEFA EARLY LEARNING" prepared by PH5 ARCHITECTURE and on file in the office of the Director Planning and Building; and any development on the lands rezoned by this Bylaw shall be in conformity with the said Comprehensive Development Plan as amended.

Read a first time this 13th day of April 2015

Read a second time this 4th day of May 2015

Read a third time this 28th day of September 2015

Reconsidered and adopted this 18th day of January 2016

MAYOR



CLERK

BYLAW NUMBER 13465 BEING A BYLAW TO AMEND BYLAW NUMBER 4742 BEING BURNABY ZONING BYLAW 1965

REZ.14-14

LEGAL: Lot 81 "A" Except: Firstly: The West 150 Feet; Secondly: Part Now Road On Statutory Right-of-Way Plan 4957; DL 124, Group 1, NWD Plan 3348

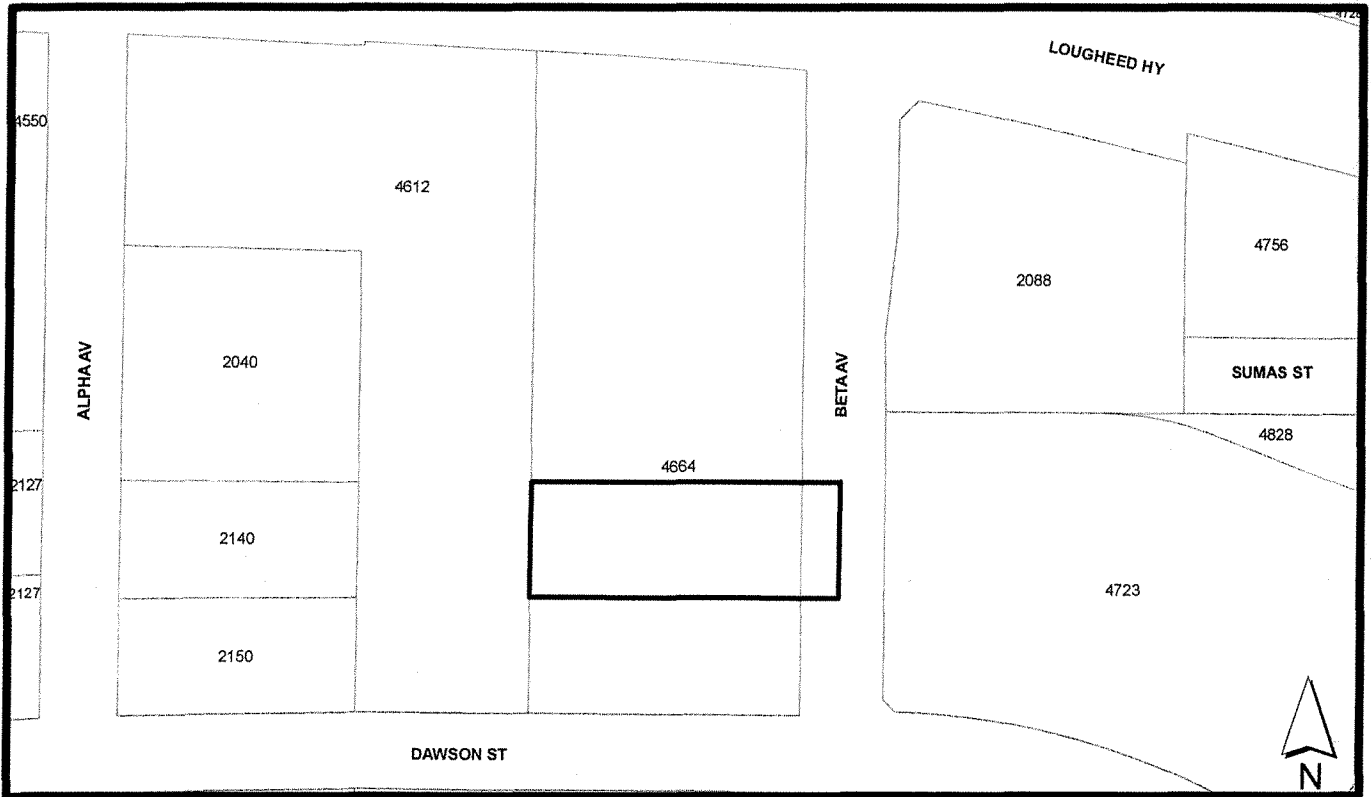

THE AREA(S) SHOWN ABOVE OUTLINED IN BLACK (——) IS (ARE) REZONED

FROM: CD Comprehensive Development District (based on M5 and M5L Light Industrial District and Brentwood Town Centre Development Plan as guidelines)

TO: Amended CD Comprehensive Development District (based on M5 Light Industrial District, P1 Neighbourhood Institutional District and Brentwood Town Centre Development Plan as guidelines and in accordance with the development plan entitled "CEFA Early Learning" prepared by ph5 architecture)

 <p>City of Burnaby</p>	<p>PLANNING AND BUILDING DEPARTMENT</p>		
<p>Date: APR 07 2015</p>	<p>OFFICIAL ZONING MAP</p>		
<p>scale: 1:2,000</p>			<p>Map "B" No. REZ. 4002</p>
<p>Drawn By: AY</p>			