

CITY OF BURNABY

BYLAW NO. 13440

A BYLAW to amend Bylaw No. 4742, being Burnaby Zoning Bylaw 1965, as amended by Bylaw Nos. 6952, 8764, and 13150 being Burnaby Zoning Bylaw 1965, Amendment Bylaw Nos. 48, 1976, 40, 1987, and 45, 2012

WHEREAS application for rezoning has been made to the Council;

AND WHEREAS the Council has held a public hearing thereon after duly giving notice of the time and place of such hearing as prescribed by Sections 892 and 893 of the *Local Government Act*, R.S.B.C. 1996;

NOW THEREFORE the Council of the City of Burnaby ENACTS as follows:

1. This Bylaw may be cited as **BURNABY ZONING BYLAW 1965, AMENDMENT BYLAW NO. 3, 2015.**

2. Bylaw No. 4742, as amended by Bylaw Nos. 6952, 8764, and 13150, is further amended as follows:

(a) The Map (hereinafter called "Map 'A'"), attached to and forming an integral part of Bylaw No. 4742, being "Burnaby Zoning Bylaw 1965", and designated as the Official Zoning Map of the City of Burnaby, is hereby amended according to the Map (hereinafter called "Map 'B'"), marginally numbered R.Z. 3992, annexed to this Bylaw, and in accordance with the explanatory legend, notations, references and boundaries designated, described, delimited and specified in particularity shown upon said Map 'B'; and the various boundaries and districts shown upon said Map 'B' respectively are an amendment of and in addition to the respective districts, designated and marked on said Map 'A' insofar as the same are changed, modified or varied thereby, and the said Map 'A' shall be deemed to be and is hereby declared to be amended accordingly and the said Map

BYLAW NUMBER 13440 BEING A BYLAW TO AMEND BYLAW NUMBER 4742 BEING BURNABY ZONING BYLAW 1965

REZ.14-38

LEGAL: Lot 1, District Lot 59, Group 1, NWD Plan BCP51902

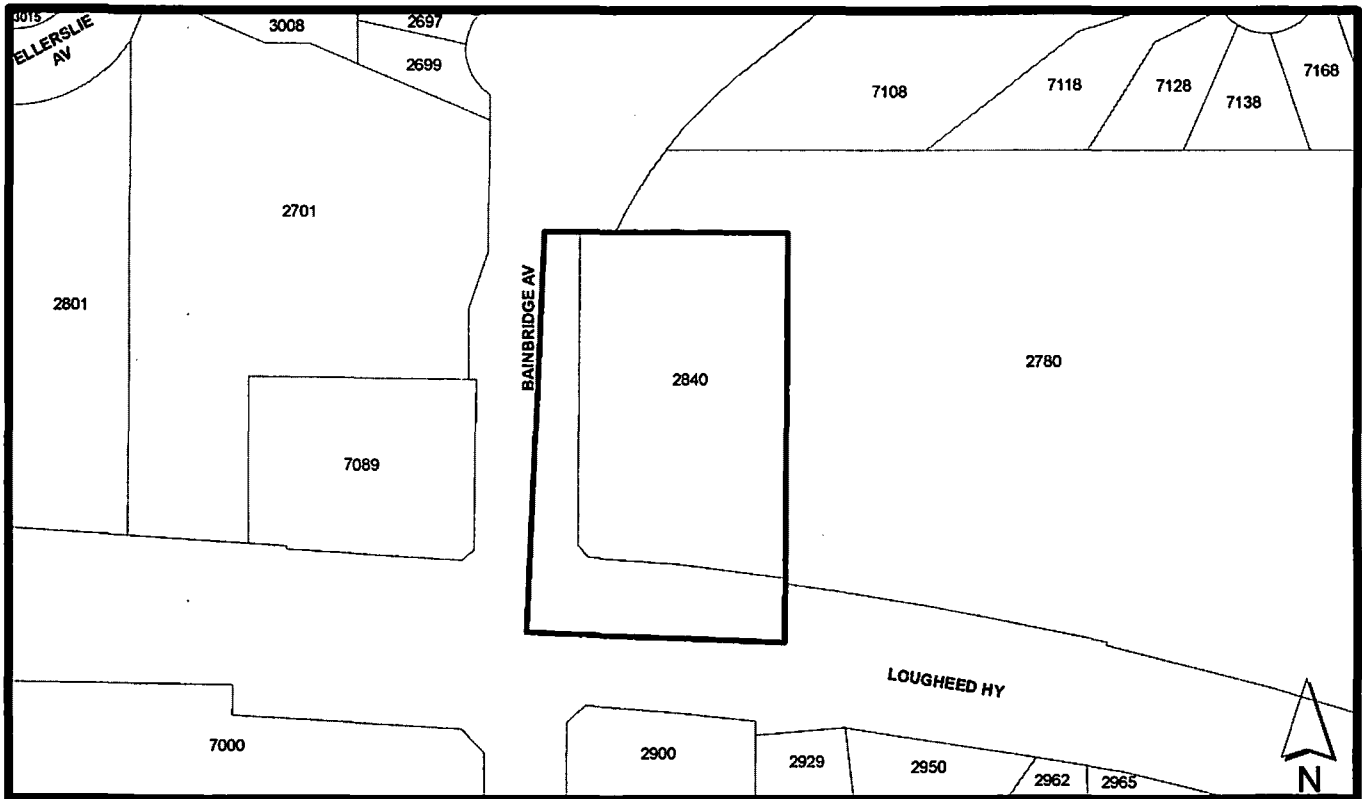

THE AREA(S) SHOWN ABOVE OUTLINED IN BLACK (——) IS (ARE) REZONED

FROM: CD Comprehensive Development District (based on C1 Neighbourhood Commercial District and P1 Neighbourhood Institutional District as guidelines and in accordance with the development plans entitled "Learning Ladder Child Care Centre" prepared by SEL Engineering Ltd.)

TO: Amended CD Comprehensive Development District (based on C1 Neighbourhood Commercial District and P1 Neighbourhood Institutional District as guidelines and in accordance with the development plans entitled "Learning Ladder Child Care Centre" prepared by SEL Engineering Ltd. as amended by the development plans entitled "Brightstart Burnaby" by Douglas R. Johnson Architect Ltd.)

	PLANNING AND BUILDING DEPARTMENT	
Date: JAN 15 2015	<p style="text-align: center;">OFFICIAL ZONING MAP</p> <p style="text-align: right;">Map "B" No. REZ. 3992</p>	
scale: 1:2,000		
Drawn By: AY		

'B' is hereby declared to be and shall form an integral part of said Map 'A', as if originally incorporated therein and shall be interpreted accordingly.

(b) The Comprehensive Development Plan more particularly described in Bylaw No. 6952, 8764, and 13150 is amended in accordance with the adopted Development Plan entitled "LEARNING LADDER CHILD CARE CENTRE" prepared by SEL ENGINEERING LTD. as amended by the development plans entitled "BRIGHTSTART BURNABY" by DOUGLAS R, JOHNSON ARCHITECT LTD. and on file in the office of the Director Planning and Building; and any development on the lands rezoned by this Bylaw shall be in conformity with the said Comprehensive Development Plan as amended.

Read a first time this 2nd day of February 2015
Read a second time this 2nd day of March 2015
Read a third time this 30th day of March 2015
Reconsidered and adopted this 30th day of March 2015



MAYOR



CLERK