

CITY OF BURNABY

BYLAW NO. 13150

A BYLAW to amend Bylaw No. 4742, being Burnaby Zoning Bylaw 1965, as amended by Bylaw No. 6952 and 8764 being Burnaby Zoning Bylaw 1965, Amendment Bylaws No. 48,1976 and 40,1987

WHEREAS application for rezoning has been made to the Council;

AND WHEREAS the Council has held a public hearing thereon after duly giving notice of the time and place of such hearing as prescribed by Sections 892 and 893 of the *Local Government Act*, R.S.B.C. 1996;

NOW THEREFORE the Council of the City of Burnaby ENACTS as follows:

1. This Bylaw may be cited as **BURNABY ZONING BYLAW 1965, AMENDMENT BYLAW NO. 45, 2012.**

2. Bylaw No. 4742, as amended by Bylaws No. 6952 and 8764, is further amended as follows:

(a) The Map (hereinafter called "Map 'A'"), attached to and forming an integral part of Bylaw No. 4742, being "Burnaby Zoning Bylaw 1965", and designated as the Official Zoning Map of the City of Burnaby, is hereby amended according to the Map (hereinafter called "Map 'B'"), marginally numbered R.Z. 3900, annexed to this Bylaw, and in accordance with the explanatory legend, notations, references and boundaries designated, described, delimited and specified in particularity shown upon said Map 'B'; and the various boundaries and districts shown upon said Map 'B' respectively are an amendment of and in addition to the respective districts, designated and marked on said Map 'A' insofar as the same are changed, modified or varied thereby, and the said Map 'A' shall be deemed to be and is hereby declared to be amended accordingly and the said Map 'B' is hereby declared to be and shall form an integral part of said Map 'A', as if originally

incorporated therein and shall be interpreted accordingly.

(b) The Comprehensive Development Plan more particularly described in Bylaws No. 6952 and 8764 is amended as may be necessary by the development plan entitled "LEARNING LADDER CHILD CARE CENTER" prepared by SEL ENGINEERING LTD. and on file in the office of the Director Planning and Building; and any development on the lands rezoned by this Bylaw shall be in conformity with the said Comprehensive Development Plan as amended.

Read a first time this 5th day of November 2012

Read a second time this 3rd day of December 2012

Read a third time this 18th day of February 2013

Reconsidered and adopted this 18th day of February 2013

MAYOR

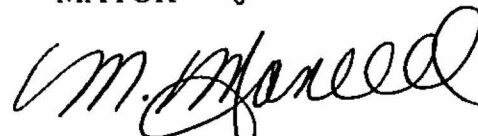
ACTING CITY CLERK

LEGAL: Lot 178, District Lot 59, Group 1, NWD Plan 52579

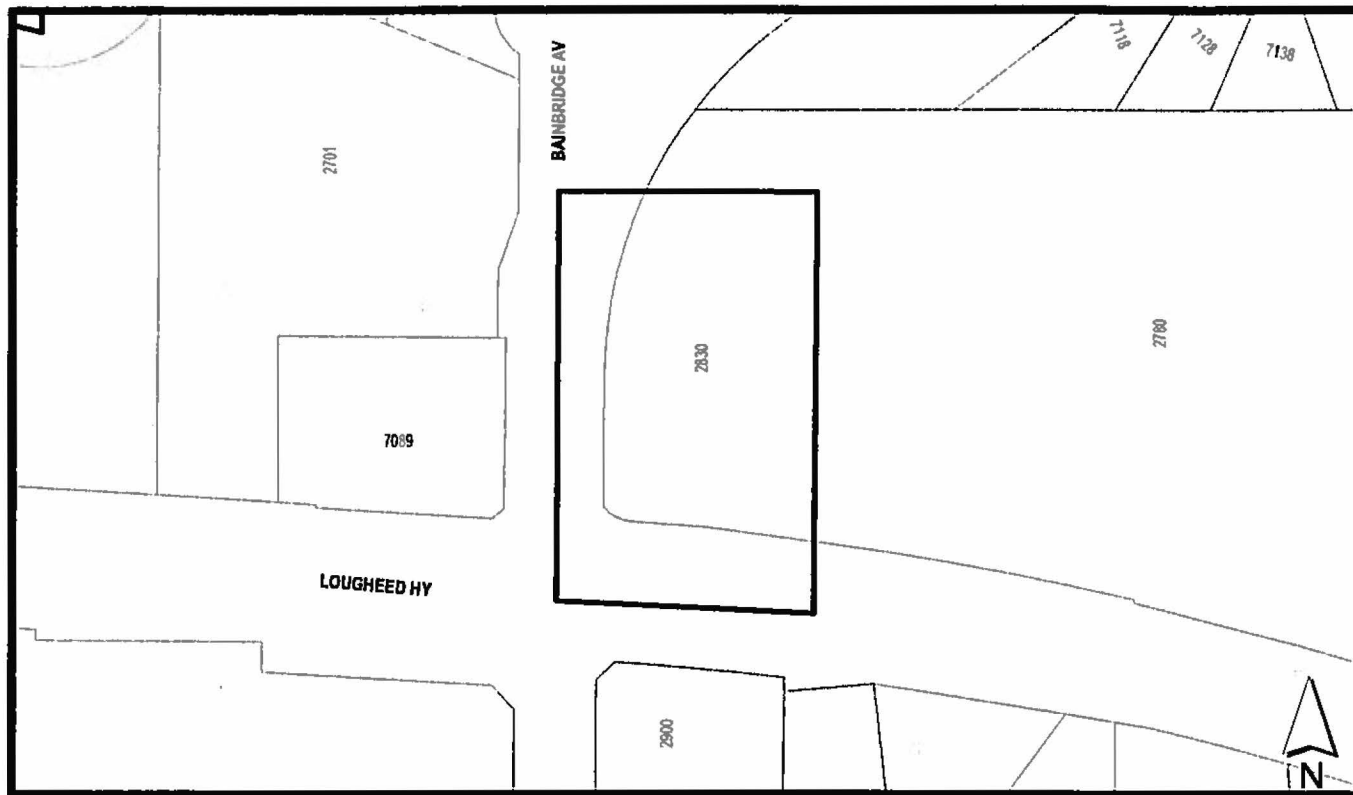

THE AREA(S) SHOWN ABOVE OUTLINED IN BLACK (——) IS (ARE) REZONED

FROM: CD Comprehensive Development District (based on C1 Neighbourhood Commercial District)

TO: Amended CD Comprehensive Development District (based on C1 Neighbourhood Commercial District and P1 Neighbourhood Institutional District as guidelines and in accordance with the development plans entitled "Learning Ladder Child Care Centre" prepared by SEL Engineering Ltd.)

	PLANNING AND BUILDING DEPARTMENT	
DATE: OCT 25 2012	<p style="text-align: center;">OFFICIAL ZONING MAP</p> <p style="text-align: right;">Map "B" 3900 No. REZ.</p>	
SCALE: 1:2,000		
DRAWN BY: AY		