

CITY OF BURNABY

BYLAW NO. 12922

A BYLAW to amend Bylaw No. 4742, being
Burnaby Zoning Bylaw 1965

WHEREAS application for rezoning has been made to the Council;

AND WHEREAS the Council has held a public hearing thereon after duly giving notice of the time and place of such hearing as prescribed by Sections 892 and 893 of the *Local Government Act*, R.S.B.C. 1996;

NOW THEREFORE the Council of the City of Burnaby ENACTS as follows:

1. This Bylaw may be cited as **BURNABY ZONING BYLAW 1965, AMENDMENT BYLAW NO. 8, 2011.**
2. The Map (hereinafter called "Map 'A'"), attached to and forming an integral part of Bylaw No. 4742, being "Burnaby Zoning Bylaw 1965", and designated as the Official Zoning Map of the City of Burnaby, is hereby amended according to the Map (hereinafter called "Map 'B'"), marginally numbered R.Z. 3824 annexed to this Bylaw, and in accordance with the explanatory legend, notations, references and boundaries designated, described, delimited and specified in particularity shown upon said Map 'B'; and the various boundaries and districts shown upon said Map 'B' respectively are an amendment of and in substitution for the respective districts, designated and marked on said Map 'A' insofar as the same are changed, modified or varied thereby, and the said Map 'A' shall be deemed to be and is hereby declared to be amended accordingly and the said Map 'B' is hereby declared to be and shall form an integral part of said Map 'A', as if originally incorporated therein and shall be interpreted accordingly.

3. The Comprehensive Development Plan represented in the report of the Director Planning and Building entitled "Rezoning of a portion of Rem. 6 except Reference Plan 14874 and except occupied portion, District Lot 85, Plan 11109 (Hart House) from P3 (Park and Public Use District) to CD (Comprehensive Development) based on P2 (Administration and Assembly District Guidelines)" dated February 23, 1988 including the sketches contained therein and on file in the office of the Director Planning and Building, is deemed to be attached to and form part of this Bylaw and any development on the lands rezoned by this Bylaw shall be in conformity with the said Comprehensive Development Plan.

Read a first time this 4th day of April 2011

Read a second time this 9th day of May 2011

Read a third time this 30th day of May 2011

Reconsidered and adopted this 30th day of May 2011



MAYOR

D. CLERK

BYLAW NUMBER 12922 BEING A BYLAW TO AMEND BYLAW
NUMBER 4742 BEING BURNABY ZONING BYLAW 1965

REZ. 11-07

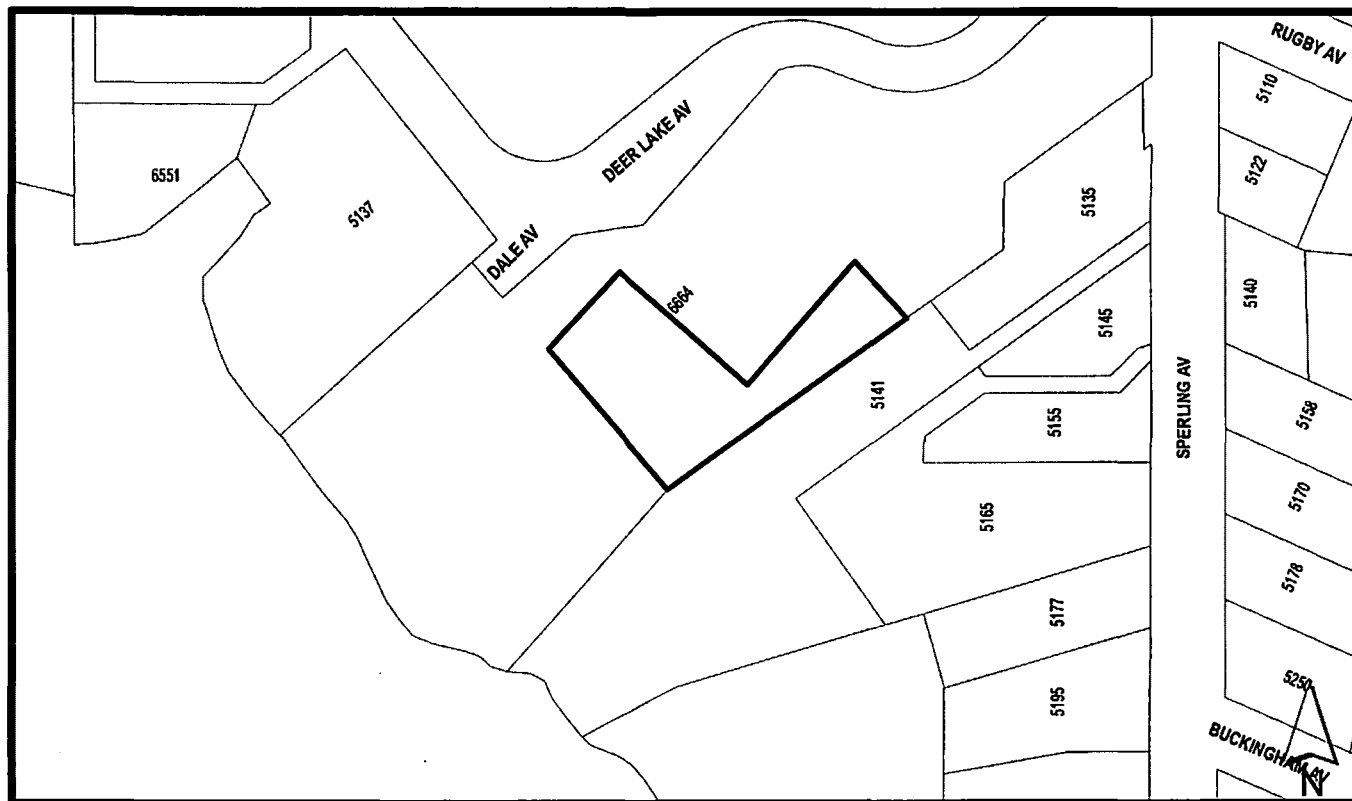
LEGAL: Portion of Lot 6 Except: Firstly: Part on Reference Plan 14874 and Secondly: Part
Subdivided by Plan 77594, District Lot 85, Group 1, NWD Plan 11109



THE AREA(S) SHOWN ABOVE OUTINED IN BLACK (——) IS (ARE) REZONED

FROM: P3 Park and Public Use District

TO: CD Comprehensive Development District (based on P2 Administration and Assembly
District)

 City of Burnaby	PLANNING & BUILDING DEPARTMENT	
DATE: AUG 16 2010	OFFICIAL ZONING MAP	
SCALE: 1:2,225		
DRAWN BY: DJ		
Map "B" 3824 No. REZ.		