

**CITY OF BURNABY**

**BYLAW NO. 12247**

A BYLAW to amend Bylaw No. 4742, being  
Burnaby Zoning Bylaw 1965

WHEREAS application for rezoning has been made to the Council;

AND WHEREAS the Council has held a public hearing thereon after duly giving notice of the time and place of such hearing as prescribed by Sections 892 and 893 of the *Local Government Act*, R.S.B.C. 1996;

NOW THEREFORE the Council of the City of Burnaby ENACTS as follows:

1. This Bylaw may be cited as **BURNABY ZONING BYLAW 1965, AMENDMENT BYLAW NO. 18, 2007.**
2. The Map (hereinafter called "Map 'A'"), attached to and forming an integral part of Bylaw No. 4742, being "Burnaby Zoning Bylaw 1965", and designated as the Official Zoning Map of the City of Burnaby, is hereby amended according to the Map (hereinafter called "Map 'B'"), marginally numbered R.Z. 3626 annexed to this Bylaw, and in accordance with the explanatory legend, notations, references and boundaries designated, described, delimited and specified in particularity shown upon said Map 'B'; and the various boundaries and districts shown upon said Map 'B' respectively are an amendment of and in substitution for the respective districts, designated and marked on said Map 'A' insofar as the same are changed, modified or varied thereby, and the said Map 'A' shall be deemed to be and is hereby declared to be amended accordingly and the said Map 'B' is hereby declared to be and shall form an integral part of said Map 'A', as if originally incorporated therein and shall be interpreted accordingly.

3. The Comprehensive Development Plan entitled "RICHVIEW TOWNHOUSES" prepared by MATTHEW CHENG ARCHITECT INC. and on file in the office of the Director Planning and Building, is deemed to be attached to and form part of this Bylaw and any development on the lands rezoned by this Bylaw shall be in conformity with the said Comprehensive Development Plan.

Read a first time this 5<sup>th</sup> day of March 2005

Read a second time this 2<sup>nd</sup> day of April 2007

Read a third time 3<sup>rd</sup> day of October 2007

Reconsidered and adopted this 21<sup>st</sup> day of April 2008

  
MAYOR

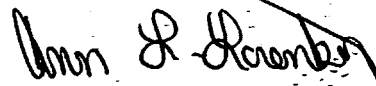
  
A/ DEPUTY CLERK

CERTIFIED A TRUE COPY  
THIS 22<sup>nd</sup> DAY OF APRIL 2008

  
AUTHORIZED SIGNATORY CLERK

**BYLAW NUMBER 12247 BEING A BYLAW TO AMEND BYLAW NUMBER 4742 BEING BURNABY ZONING BYLAW 1965**

**LEGAL:** Lot 12 and West Half of Lot 11, Blk 27, D.L. 69, Group 1, NWD Plan 1321

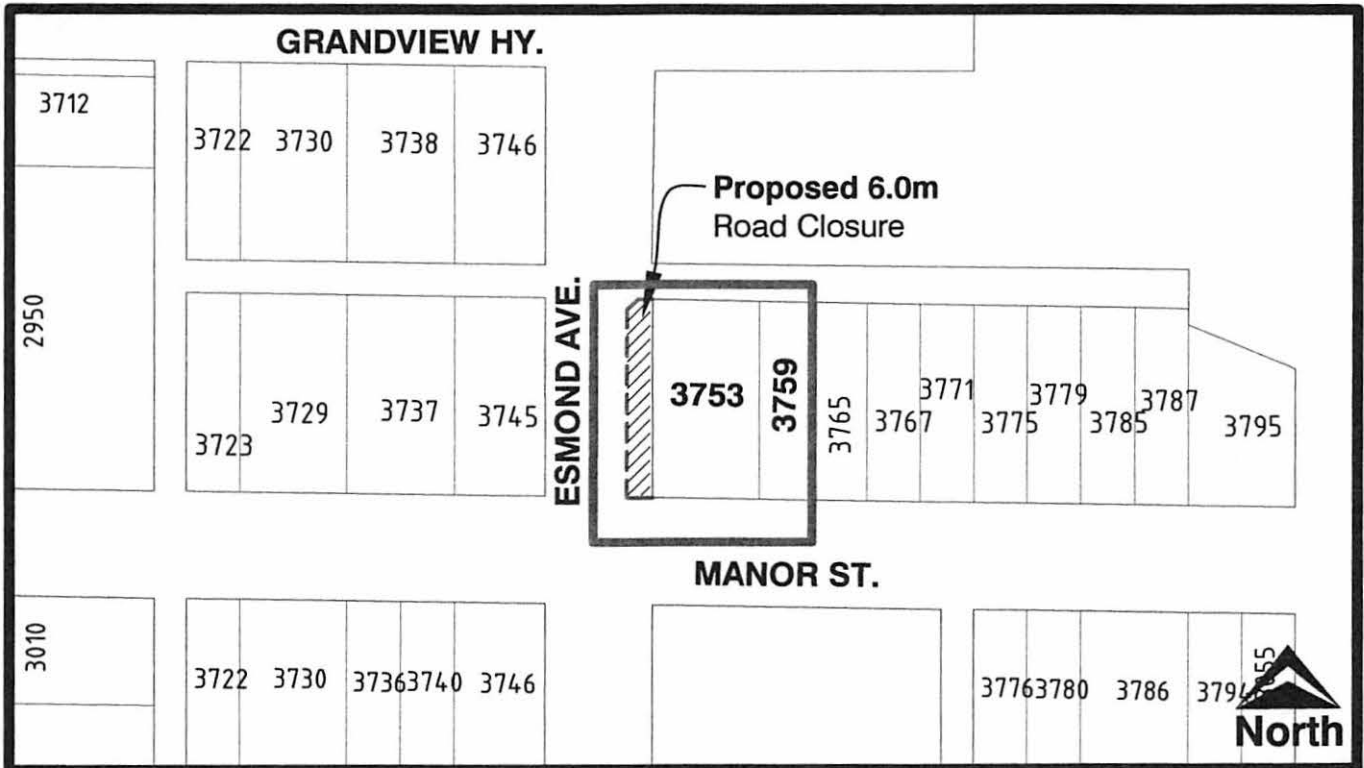

**THE AREA(S) SHOWN ABOVE OUTLINED IN BLACK ( — ) IS (ARE) REZONED**

**FROM:** R5 Residential District

**TO:** CD Comprehensive Development District (based on RM2 Multiple Family Residential District and Community Plan Eight guidelines and in accordance with the development plan entitled "Richview Townhouses" prepared by Matthew Cheng Architect Inc.)



**Planning and Building Department**

**Scale:** N.T.S.

**Drawn By:** J.P.C.

**Date:** March 2007

**OFFICIAL ZONING MAP**

**Map "B"**

**NO.REZ. 3626**