

CITY OF BURNABY

BYLAW NO. 11350

A BYLAW to amend Bylaw No. 4742, being Burnaby Zoning Bylaw 1965, as amended by Bylaw No. 5661, being Burnaby Zoning Bylaw 1965, Amendment Bylaw No. 4, 1970, Bylaw No. 7947, being Burnaby Zoning Bylaw 1965, Amendment Bylaw No. 48, 1982, Bylaw No. 8405, being Burnaby Zoning Bylaw 1965, Amendment Bylaw No. 45, 1985, and Bylaw No. 10530, being Burnaby Zoning Bylaw 1965, Amendment Bylaw No. 5, 1997

WHEREAS application for rezoning has been made to the Council;

AND WHEREAS the Council has held a public hearing thereon after duly giving notice of the time and place of such hearing as prescribed by Sections 892 and 893 of the *Local Government Act*, R.S.B.C. 1996;

NOW THEREFORE the Council of the City of Burnaby ENACTS as follows:

1. This Bylaw may be cited as **BURNABY ZONING BYLAW 1965, AMENDMENT BYLAW NO. 8, 2002.**

2. Bylaw No 4742, as amended by Bylaw Nos. 5661, 7947, 8405, and 10530 is further amended as follows:

(a) The Map (hereinafter called "Map 'A'"), attached to and forming an integral part of Bylaw No. 4742, being "Burnaby Zoning Bylaw 1965", and designated as the Official Zoning Map of the City of Burnaby, is hereby amended according to the Map (hereinafter called "Map 'B'"), marginally numbered R.Z. 3309, annexed to this Bylaw, and in accordance with the explanatory legend, notations, references and boundaries designated, described, delimited and specified in particularity shown upon said Map 'B'; and the various boundaries and districts shown upon said

(b) The Comprehensive Development Plan more particularly described in Bylaw Nos. 9835, 10267 is amended as may be necessary by the development plan entitled "GILMORE PARKING" prepared by JOHNSTON DAVIDSON ARCHITECTURE & PLANNING INC. and on file in the office of the Director Planning and Building; and any development on the lands rezoned by this Bylaw shall be in conformity with the said Comprehensive Development Plan as amended.

Read a first time this 4th day of March 2002

Read a second time this 8th day of April 2002

Read a third time 24th day of June 2002

Reconsidered and adopted this 22nd day of July 2002

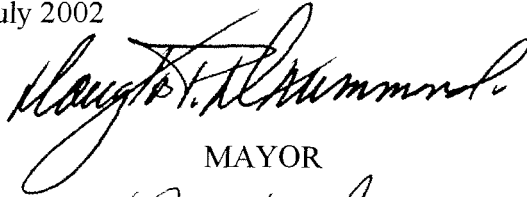

MAYOR



CLERK

BYLAW NUMBER 11350 BEING A BYLAW TO AMEND BYLAW NUMBER 4742 BEING BURNABY ZONING BYLAW 1965

LEGAL: Lot 2, D.L. 120, Group 1, NWD Plan LMP 34459

K

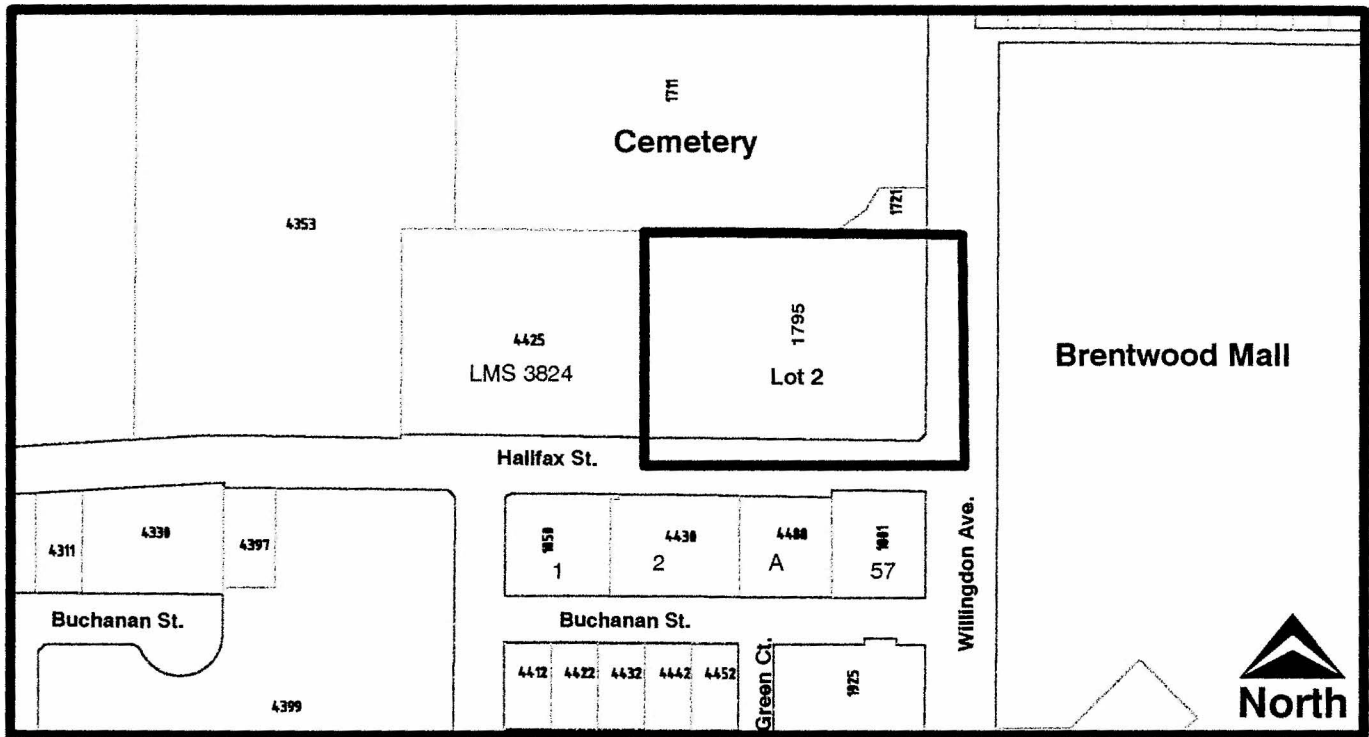

THE AREA(S) SHOWN ABOVE OUTLINED IN BLACK (—) IS (ARE) REZONED

FROM: CD Comprehensive Development District (based on P2 Administration and Assembly District, P6 Regional Institutional District, RM5 Multiple Family Residential District)

TO: CD Comprehensive Development District (based on P2 Administration and Assembly District, P6 Regional Institutional District, RM5 Multiple Family Residential District and C3 General Commercial District and in accordance with the development plan entitled "Education Centre" prepared by Telus)

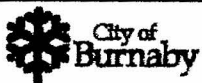

Planning And Building Department

Scale: N.T.S.

Drawn By: J.P.C.

Date: March 2002

OFFICIAL ZONING MAP
Map "B"

NO.REZ. 3309