

CITY OF BURNABY

BYLAW NO. 11112

A BYLAW to amend Bylaw No. 4742, being
Burnaby Zoning Bylaw 1965

WHEREAS application for rezoning has been made to the Council;

AND WHEREAS the Council has held a public hearing thereon after duly giving notice of the hearing as prescribed by sections 892 and 893 of the *Municipal Act* R.S.B.C. 1996;

NOW THEREFORE the Council of the City of Burnaby ENACTS as follows:

1. This Bylaw may be cited as **BURNABY ZONING BYLAW 1965, AMENDMENT BYLAW NO. 21, 2000.**

2. The map (hereinafter called "Map 'A'") attached to and forming an integral part of Bylaw No. 4742, being Burnaby Zoning Bylaw 1965, and designated as the Official Zoning Map of the City of Burnaby, is hereby amended according to the Map (hereinafter called "Map 'B'"), marginally numbered R.Z. 3248 annexed to this Bylaw, and in accordance with the explanatory legend, notations, references and boundaries designated, described, delimited and specified in particularity shown upon said Map 'B', and the various boundaries and districts shown upon said Map 'B', respectively are an amendment of and in substitution for the respective districts, designated and marked on said Map 'A' insofar as the same are changed, modified or varied thereby, and the said Map 'A' shall be deemed to be and is hereby declared to be amended accordingly and the said Map 'B' is hereby declared to be and shall form an integral part of said Map 'A' as if originally incorporated therein and shall be interpreted accordingly.

Read a first time this	12 th	day of	June	2000
Read a second time this	10 th	day of	July	2000
Read a third time	31 st	day of	July	2000
Reconsidered and adopted this	31 st	day of	July	2000



MAYOR



CLERK

BYLAW NUMBER 11112 BEING A BYLAW TO AMEND BYLAW NUMBER 4742 BEING BURNABY ZONING BYLAW 1965

LEGAL: Lot C, DL 93, Group 1, NWD Plan 3245, Lot 5, 6, 7, 8, 9, 10, 11, 12, 13, 14, 15, 16, 17, Blk 2, DL 93, Group 1, NWD Plan 1462; Lot 1, 2, 3, 4, DL 93, Group 1, NWD Plan 2698, Lot D, DL 93, Group 1, NWD Plan 3245, Lot B, DL 93, Group 1, NWD Plan 3248, Lot A except: the north 297.4 feet, DL 93, Group 1, NWD Plan 3248, Lot 30, 29, 28, 27, 26, 25, 24, 23, 22, 21, 20, 19, 18, Blk 2, DL 93, Group 1, NWD Plan 1462, Lot 8, 7, 6, DL 92, Group 1, NWD Plan 1146; Lot 34, 35, 36, 38, 39, 40, 41, DL 93, Group 1, NWD Plan 1127; Lot 31, 30, 29, 16, 28, 27, 26, DL 93, Group 1, NWD Plan 1127; Lot 4, 3, 2, 1, Blk 2, DL 93, Group 1, NWD Plan 1462, Lot 8, DL 93, Group 1, NWD Plan 1127, Lot 7 except: the south 10 feet, DL 93, Group 1, NWD Plan 1127; North half of Lot 3 except the east 33 feet dedicated road on Plan 30133, DL 93, Group 1, NWD Plan 284; Lot 1, DL 92, Group 1, NWD Plan 1146

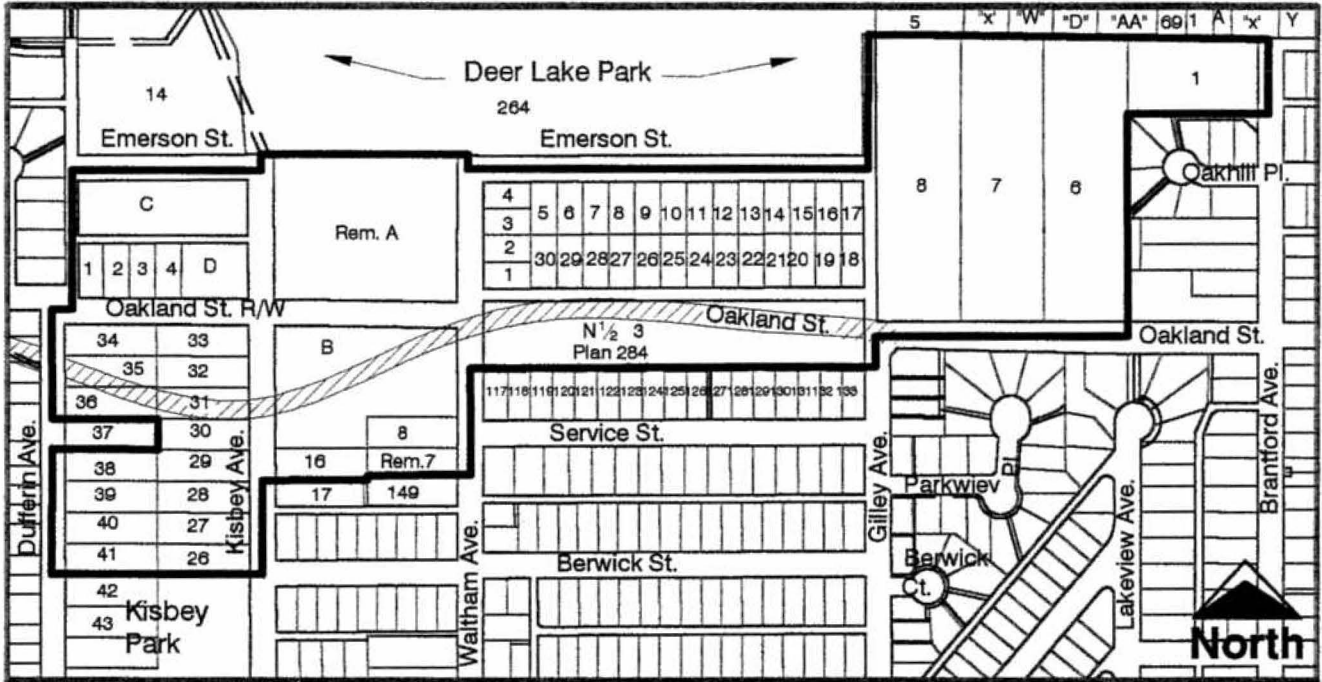

THE AREA(S) SHOWN ABOVE OUTLINED IN BLACK (———) IS (ARE) REZONED

FROM: R2 and R4 Residential District

TO: P3 Park and Public Use District



Planning And Building Department

Scale: N.T.S.

Drawn By: J.P.C.

Date: May 2000

OFFICIAL ZONING MAP

MAP "B"

NO. REZ. 3248