

CITY OF BURNABY

BYLAW NO. 10730

A BYLAW to amend Bylaw No. 4742, being  
Burnaby Zoning Bylaw 1965

WHEREAS application for rezoning has been made to the Council;

AND WHEREAS the Council has held a public hearing thereon after duly giving notice of the time and place of such hearing as prescribed by Sections 892 and 893 of the *Municipal Act*, R.S.B.C. 1996;

NOW THEREFORE the Council of the City of Burnaby ENACTS as follows:

1. This Bylaw may be cited as BURNABY ZONING BYLAW 1965, AMENDMENT BYLAW NO. 17, 1998.
2. The Map (hereinafter called "Map 'A'"), attached to and forming an integral part of Bylaw No. 4742, being "Burnaby Zoning Bylaw 1965", and designated as the Official Zoning Map of the City of Burnaby, is hereby amended according to the Map (hereinafter called "Map 'B'"), marginally numbered R.Z. 3141, annexed to this Bylaw, and in accordance with the explanatory legend, notations, references and boundaries designated, described, delimited and specified in particularity shown upon said Map 'B'; and the various boundaries and districts shown upon said Map 'B' respectively are an amendment of and in substitution for the respective districts, designated and marked on said Map 'A' insofar as the same are changed, modified or varied thereby, and the said Map 'A' shall be deemed to be and is hereby declared to be

amended accordingly and the said Map 'B' is hereby declared to be and shall form an integral part of said Map 'A', as if originally incorporated therein and shall be interpreted accordingly.

3. The Burnaby Business Park Guidelines and the Comprehensive Development Plan entitled "BRIDGE BUSINESS PARK: LOT C" prepared by JOHN HOLLIFIELD ARCHITECT INC. and on file in the office of the Director Planning and Building, are deemed to be attached to and form part of this Bylaw and any development on the lands rezoned by this Bylaw shall be in conformity with the said Guidelines and Comprehensive Development Plan.

Read a first time this 2<sup>nd</sup> day of MARCH 1998

Read a second time this 6<sup>th</sup> day of APRIL 1998

Read a third time 15<sup>th</sup> day of JUNE 1998

Received the approval of the Minister of Transportation and Highways  
this 29<sup>th</sup> day of JUNE 1998

Reconsidered and adopted this 14<sup>th</sup> day of SEPTEMBER 1998



MAYOR



CLERK

**BYLAW NUMBER 10730 BEING A BYLAW TO AMEND  
BYLAW NUMBER 4742 BEING THE BURNABY ZONING BYLAW 1965**

**PROPERTY REZONED TO:** AMENDED CD COMPREHENSIVE DEVELOPMENT DISTRICT (BASED ON M5 LIGHT INDUSTRIAL DISTRICT AND THE BRIDGE BUSINESS PARK GUIDELINES AND IN ACCORDANCE WITH THE DEVELOPMENT PLAN ENTITLED "BRIDGE BUSINESS PARK: LOT C" PREPARED BY JOHN HOLLIFIELD ARCHITECT INC.)

**LEGAL:** LOT C, D.L. 118, GROUP 1, NWD PLAN LMP2973

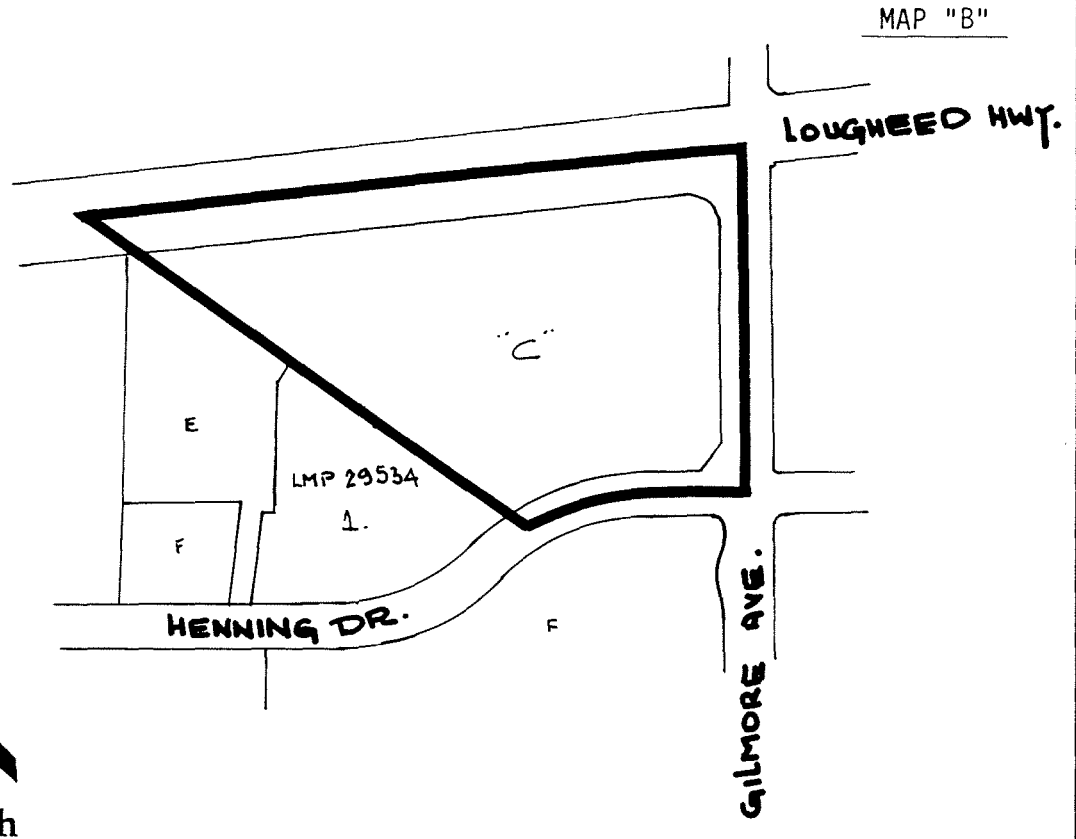

**THE AREA(S) SHOWN  
ABOVE OUTLINED  
IN BLACK (———)  
IS (ARE) REZONED:**

**FROM:** CD COMPREHENSIVE DEVELOPMENT DISTRICT (BASED ON M5 LIGHT INDUSTRIAL DISTRICT AND BRIDGE BUSINESS PARK DEVELOPMENT GUIDELINES)

**TO:** CD COMPREHENSIVE DEVELOPMENT DISTRICT (BASED ON M5 LIGHT INDUSTRIAL DISTRICT AND THE BRIDGE BUSINESS PARK GUIDELINES AND IN ACCORDANCE WITH THE DEVELOPMENT PLAN ENTITLED "BRIDGE BUSINESS PARK: LOT C" PREPARED BY JOHN HOLLIFIELD ARCHITECT INC.)

<b>PLANNING DEPARTMENT</b>	
SCALE	1:4000
DRAWN	J.P.C.
DATE	FEB. 1997



**OFFICIAL ZONING MAP**