

CITY OF BURNABY

BYLAW NO. 10589

A BYLAW to amend Bylaw No. 4742, being
Burnaby Zoning Bylaw 1965

WHEREAS application for rezoning has been made to the Council;

AND WHEREAS the Council has held a public hearing thereon after duly giving notice of the hearing as prescribed by sections 956 and 957 of the Municipal Act R.S.B.C. 1979;

NOW THEREFORE the Council of the City of Burnaby ENACTS as follows:

1. This Bylaw may be cited as BURNABY ZONING BYLAW 1965, AMENDMENT BYLAW NO. 30, 1997.
2. The map (hereinafter called "Map 'A'") attached to and forming an integral part of Bylaw No. 4742, being Burnaby Zoning Bylaw 1965, and designated as the Official Zoning Map of the City of Burnaby, is hereby amended according to the Map (hereinafter called "Maps 'B'"), marginally numbered R.Z. 3092 annexed to this Bylaw, and in accordance with the explanatory legend, notations, references and boundaries designated, described, delimited and specified in particularity shown upon said Maps 'B', and the various boundaries and districts shown upon said Maps 'B', respectively are an amendment of and in substitution for the respective districts, designated and marked on said Map 'A' insofar as the same are changed, modified or varied thereby, and the said Map 'A' shall be deemed to be and is hereby declared to be amended accordingly and the said Map 'B' is hereby declared to be and shall form an

integral part of said Map 'A' as if originally incorporated therein and shall be interpreted accordingly.

Read a first time this 2nd day of JUNE 1997

Read a second time this 7th day of JULY 1997

Read a third time 11th day of AUGUST 1997

Received the approval of the Minister of Transportation and Highways

this 21st day of AUGUST 1997

Reconsidered and adopted this 25th day of AUGUST 1997

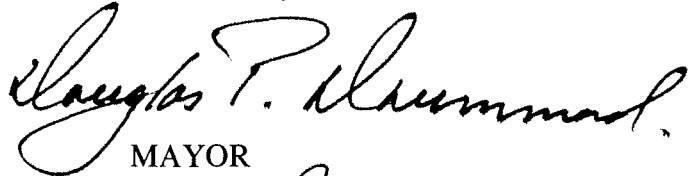
MAYOR

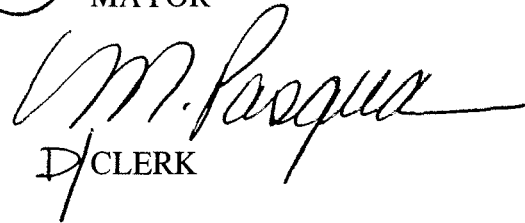
D/CLERK

**BYLAW NUMBER 10589 BEING A BYLAW TO AMEND
BYLAW NUMBER 4742 BEING THE BURNABY ZONING BYLAW 1965**

PROPERTY REZONED TO:

C3a GENERAL COMMERCIAL DISTRICT

**LEGAL: PTN. LOT 113 EXCEPT: PART SUBDIVIDED BY PLAN 27154, D.L. 122 ABD 124, GROUP 1,
NWD PLAN 26085**

MAP "B"

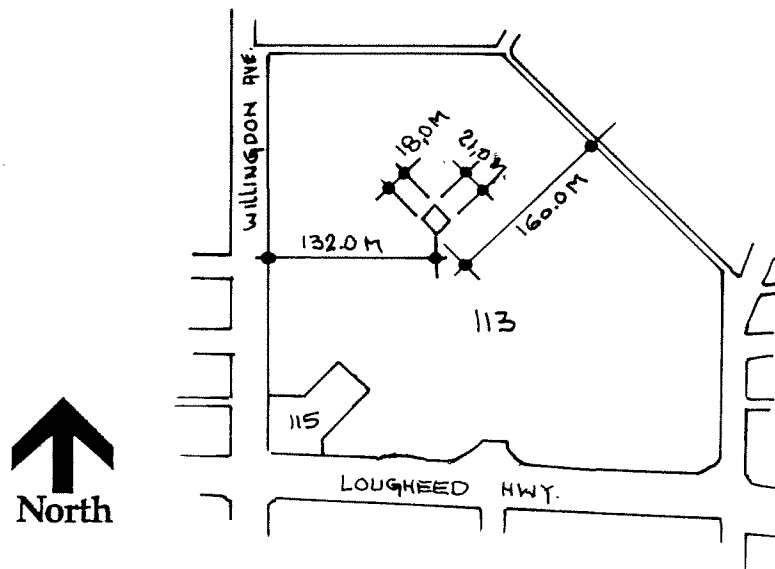

**THE AREA(S) SHOWN
ABOVE OUTLINED
IN BLACK (———)
IS (ARE) REZONED:**

FROM: C3 GENERAL COMMERCIAL DISTRICT

TO: C3a GENERAL COMMERCIAL DISTRICT

**PLANNING
DEPARTMENT**

SCALE N.T.S.

DRAWN J.P.C.

DATE MAY 1997



City of
Burnaby

OFFICIAL ZONING MAP

No. RZ 3092