

CITY OF BURNABY

BYLAW NO. 10558

A BYLAW to amend Bylaw No. 4742, being
Burnaby Zoning Bylaw 1965

WHEREAS application for rezoning has been made to the Council;

AND WHEREAS the Council has held a public hearing thereon after duly giving notice of the hearing as prescribed by sections 956 and 957 of the Municipal Act R.S.B.C. 1979;

NOW THEREFORE the Council of the City of Burnaby ENACTS as follows:

1. This Bylaw may be cited as BURNABY ZONING BYLAW 1965, AMENDMENT BYLAW NO. 16, 1997.
2. The map (hereinafter called "Map 'A'") attached to and forming an integral part of Bylaw No. 4742, being Burnaby Zoning Bylaw 1965, and designated as the Official Zoning Map of the City of Burnaby, is hereby amended according to the Map (hereinafter called "Maps 'B'"), marginally numbered R.Z. 3078 annexed to this Bylaw, and in accordance with the explanatory legend, notations, references and boundaries designated, described, delimited and specified in particularity shown upon said Maps 'B', and the various boundaries and districts shown upon said Maps 'B', respectively are an amendment of and in substitution for the respective districts, designated and marked on said Map 'A' insofar as the same are changed, modified or varied thereby, and the said Map 'A' shall be deemed to be and is hereby declared to be amended accordingly and the said Map 'B' is hereby declared to be and shall form an

integral part of said Map 'A' as if originally incorporated therein and shall be interpreted accordingly.

Read a first time this	7 th	day of	APRIL	1997
Read a second time this	5 th	day of	MAY	1997
Read a third time	2 nd	day of	MARCH	1998
Reconsidered and adopted this	23 rd	day of	MARCH	1998

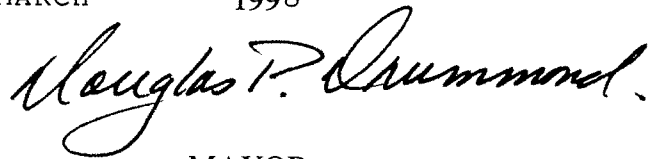

MAYOR



CLERK

**BYLAW NUMBER 10558 BEING A BYLAW TO AMEND
BYLAW NUMBER 4742 BEING THE BURNABY ZONING BYLAW 1965**

PROPERTY REZONED TO: M5 LIGHT INDUSTRIAL DISTRICT

LEGAL: PTN. OF LOT 39, D.L. 166A, GROUP 1, NWD PLAN 48494

MAP "B"

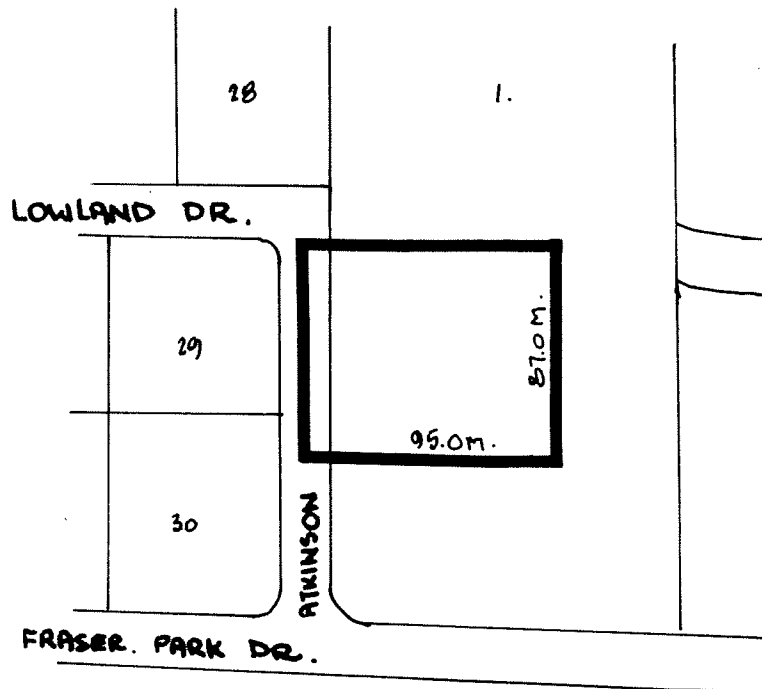

THE AREA(S) SHOWN
ABOVE OUTLINED
IN BLACK (———)
IS (ARE) REZONED:

FROM: CD COMPREHENSIVE DEVELOPMENT DISTRICT (BASED ON M1 MANUFACTURING DISTRICT
AND M5 LIGHT INDUSTRIAL DISTRICT)

TO: M5 LIGHT INDUSTRIAL DISTRICT

PLANNING
DEPARTMENT

SCALE 1: 3000

DRAWN J.P.C.

DATE MARCH 1997



City of
Burnaby

OFFICIAL ZONING MAP

No. RZ 3078