

CITY OF BURNABY

BYLAW NO. 10363

A BYLAW to amend Bylaw No. 4742, being
Burnaby Zoning Bylaw 1965

WHEREAS application for rezoning has been made to the Council;



AND WHEREAS the Council has held a public hearing thereon after duly giving notice of the hearing as prescribed by sections 956 and 957 of the Municipal Act R.S.B.C. 1979;

NOW THEREFORE the Council of the City of Burnaby ENACTS as follows:

1. This Bylaw may be cited as BURNABY ZONING BYLAW 1965, AMENDMENT BYLAW NO. 21, 1996.
2. The map (hereinafter called "Map 'A'") attached to and forming an integral part of Bylaw No. 4742, being Burnaby Zoning Bylaw 1965, and designated as the Official Zoning Map of the City of Burnaby, is hereby amended according to the Map (hereinafter called "Maps 'B'"), marginally numbered R.Z. 3029 annexed to this Bylaw, and in accordance with the explanatory legend, notations, references and boundaries designated, described, delimited and specified in particularity shown upon said Maps 'B', and the various boundaries and districts shown upon said Maps 'B', respectively are an amendment of and in substitution for the respective districts, designated and marked on said Map 'A' insofar as the same are changed, modified or varied thereby, and the said Map 'A' shall be deemed to be and is hereby declared to be amended accordingly and the said Map 'B' is hereby declared to be and shall form an

integral part of said Map 'A' as if originally incorporated therein and shall be interpreted accordingly.

Read a first time this	1 st	day of	APRIL	199 6
Read a second time this	6 th	day of	MAY	199 6
Read a third time this	13	day of	MAY	199 6
Reconsidered and adopted this	27 th	day of	MAY	199 6



MAYOR

CLERK

**BYLAW NUMBER 10363 BEING A BYLAW TO AMEND
BYLAW NUMBER 4742 BEING THE BURNABY ZONING BYLAW 1965**

PROPERTY REZONED TO: R10 RESIDENTIAL DISTRICT

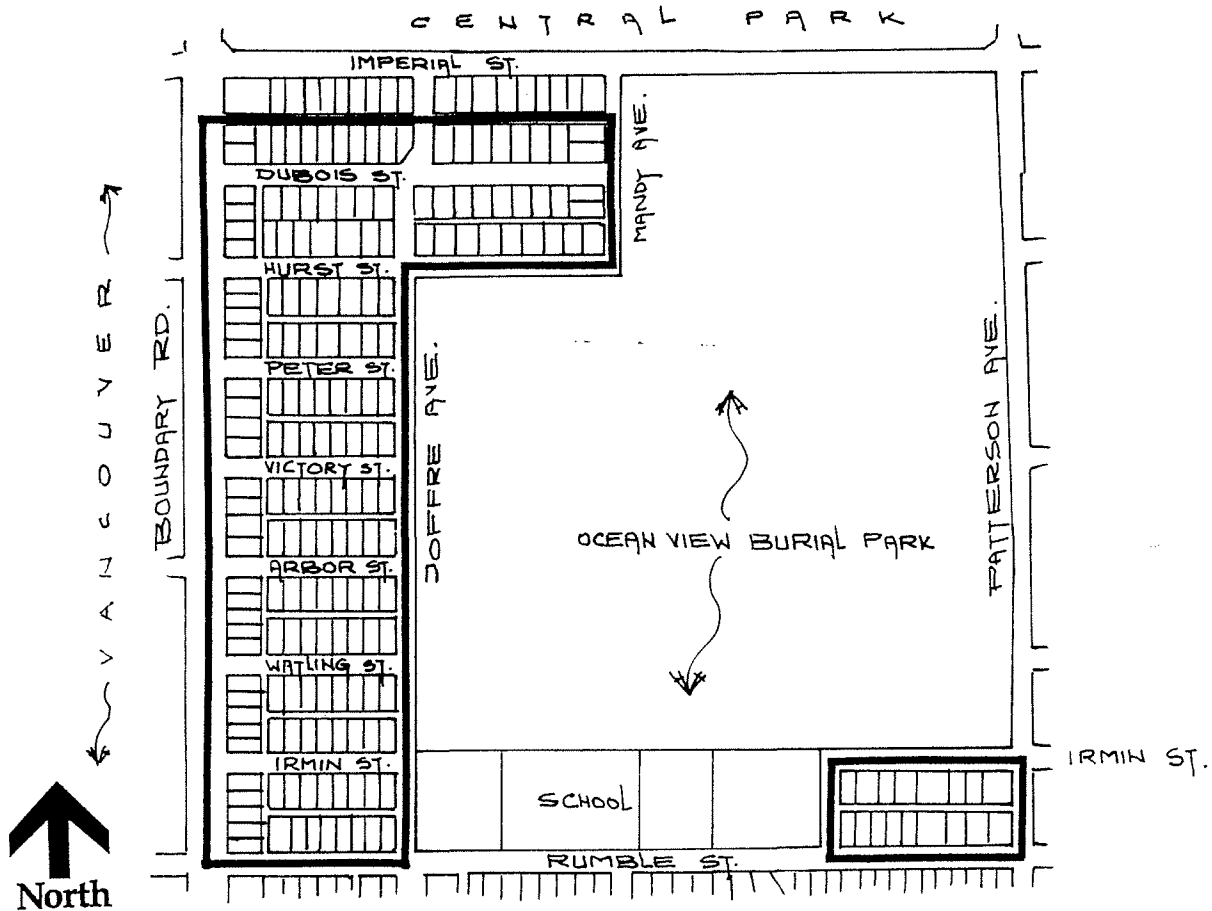
LEGAL: SEE ATTACHED SCHEDULE "A"

MAP "B"



**THE AREA(S) SHOWN
ABOVE OUTLINED
IN BLACK (———)
IS (ARE) REZONED:**

FROM: R3 RESIDENTIAL DISTRICT

TO: R10 RESIDENTIAL DISTRICT

**PLANNING
DEPARTMENT**

SCALE N.T.S.

DRAWN J.P.C.

DATE APRIL 1996



City of
Burnaby

OFFICIAL ZONING MAP

No. RZ 3029

**Rezoning Reference #1/96
Schedule "A"**

1.	3721 Dubois St.	Lot 21, Blk 14, DL 150, Grp 1, Plan 15057
2.	3729 Dubois St.	Lot 22, DL 150 Grp 1, Plan 15057
3.	3730 Dubois St.	Lot N, DL 150, Grp 1, Plan 15990
4.	3736 Dubois St.	Lot M, DL 150, Grp 1, Plan 15990
5.	3737 Dubois St.	Lot 23, DL 150, Grp 1, Plan 15057
6.	3745 Dubois St.	Lot 24, Blk 14, Lot 150, Grp 1, Plan 15057
7.	3746 Dubois St.	Lot L, DL 150, Grp 1, Plan 15990
8.	3753 Dubois St.	Lot 25, DL 150, Grp 1, Plan 15057
9.	3754 Dubois St.	Lot K, DL 150, Grp 1, Plan 15990
10.	3761 Dubois St.	Lot 26, Blk 14, DL 150, Grp 1, Plan 15057
11.	3769 Dubois St.	Lot 27, Blk 14, DL 150, Grp 1, Plan 15057
12.	3772 Dubois St.	Lot J, Blk C, DL 150, Grp 1, Plan 15057
13.	3777 Dubois St.	Lot 28, Blk 14, DL 150, Grp 1, Plan 15057
14.	3782 Dubois St.	Lot H, Blk C, DL 150, Grp 1, Plan 15057
15.	3785 Dubois St.	Lot 29, DL 150, Grp 1, Plan 15057
16.	3793 Dubois St.	Lot 30, Blk 14, DL 150, Plan 15057
17.	3794 Dubois St.	Lot G, DL 150, Grp 1, Plan 15057
18.	3814 Dubois St.	Lot 45, DL 150, Grp 1, Plan 15609
19.	3825 Dubois St.	Lot 9, DL 150, Grp 1, Plan 15981
20.	3826 Dubois St.	Lot 46, DL 150, Grp 1, Plan 15609
21.	3836 Dubois St.	Lot 47, DL 150, Grp 1, Plan 15609
22.	3837 Dubois St.	Lot 8, DL 150, Grp 1, Plan 15981
23.	3849 Dubois St.	Lot 7, DL 150, Grp 1, Plan 15981
24.	3850 Dubois St.	Lot 48, DL 150, Grp 1, Plan 15609
25.	3857 Dubois St.	Lot 6, DL 150, Grp 1, Plan 15981
26.	3858 Dubois St.	Lot 49, DL 150, Grp 1, Plan 15609
27.	3869 Dubois St.	Lot 5, DL 150, Grp 1, Plan 15981
28.	3870 Dubois St.	Lot 50, DL 150, Grp 1, Plan 15609
29.	3879 Dubois St.	Lot 4, DL 150, Grp 1, Plan 15981
30.	3880 Dubois St.	Lot 51, DL 150, Grp 1, Plan 15609
31.	3705 Hurst St.	Lot 2, DL 150, Grp 1, Plan 23738
32.	3712 Hurst St.	Lot 33, DL 150, Grp 1, Plan 28927
33.	3717 Hurst St.	Lot 3, DL 150, Grp 1, Plan 23738
34.	3726 Hurst St.	Lot N, DL 150, Grp 1, Plan 16045
35.	3727 Hurst St.	Lot 37, DL 150, Grp 1, Plan 47900
36.	3736 Hurst St.	Lot O, DL 150, Grp 1, Plan 16045
37.	3747 Hurst St.	Lot 38, DL 150, Grp 1, Plan 47900
38.	3750 Hurst St.	Lot P, DL 150, Grp 1, Plan 16045
39.	3759 Hurst St.	East 85 Feet Lot B, DL 150, Grp 1, Plan 8581
40.	3760 Hurst St.	Lot Q, DL 150, Grp 1, Plan 20950
41.	3771 Hurst St.	Lot C except: part included in (EP13922), DL 150, Grp 1, Plan 8581
42.	3772 Hurst St.	Lot 10 except: firstly: part road plan 14773 secondly: parcel K (EP14344) and lane, DL 150, Grp 1, Plan 1357
43.	3781 Hurst St.	Lot E, DL 150, Grp 1, Plan 15057
44.	3782 Hurst St.	Lot J, DL 150, Grp 1, Plan 14473
45.	3794 Hurst St.	Lot H, DL 150, Grp 1, Plan 14473
46.	3805 Hurst St.	Lot 36, DL 150, Grp 1, Plan 15420
47.	3815 Hurst St.	Lot 37, DL 150, Grp 1, Plan 15420
48.	3827 Hurst St.	Lot 38, DL 150, Grp 1, Plan 15420
49.	3837 Hurst St.	Lot 39, DL 150, Grp 1, Plan 15420
50.	3849 Hurst St.	Lot 40, DL 150, Grp 1, Plan 15420

51.	3859 Hurst St.	Lot 41, DL 150, Grp 1, Plan 15420
52.	3871 Hurst St.	Lot 42, DL 150, Grp 1, Plan 15420
53.	3881 Hurst St.	Lot 53, DL 150, Grp 1, Plan 15768
54.	3893 Hurst St.	Lot 54, DL 150, Grp 1, Plan 15768
55.	3711 Peter St.	Lot A, DL 150, Grp 1, Plan 14473
56.	3726 Peter St.	Lot Q, DL 150, Grp 1, Plan 14473
57.	3727 Peter St.	Lot C, DL 150, Grp 1, Plan 14473
58.	3736 Peter St.	Lot P, Blk 1, DL 150, Grp 1, Plan 14473
59.	3737 Peter St.	Lot D, DL 150, Grp 1, Plan 14473
60.	3746 Peter St.	Lot O, DL 150, Grp 1, Plan 14473
61.	3749 Peter St.	Lot E, DL 150, Grp 1, Plan 14473
62.	3753 Peter St.	Lot R, DL 150, Grp 1, Plan 20950
63.	3756 Peter St.	Lot N, Blk 1, DL 150, Grp 1, Plan 14473
64.	3759 Peter St.	Parcel K (EP14344) Lot 10, DL 150, Grp 1, Plan 1357
65.	3766 Peter St.	Lot M, Blk 1, DL 150, Grp 1, Plan 14473
66.	3776 Peter St.	Lot L, Blk 1, DL 150, Grp 1, Plan 14473
67.	3781 Peter St.	Lot F, DL 150, Grp 1, Plan 14473
68.	3786 Peter St.	Lot K, Blk 1, DL 150, Grp 1, Plan 14473
69.	3793 Peter St.	Lot G, DL 150, Grp 1, Plan 14473
70.	3796 Peter St.	Lot J, Blk 1, DL 150, Grp 1, Plan 14473
71.	3714 Victory St.	Lot 1, Blk 3, DL 150, Grp 1, Plan 2041
72.	3715 Victory St.	Lot 4, Blk 1, DL 150, Grp 1, Plan 2041
73.	3726 Victory St.	Lot P, Blk 3, DL 150, Grp 1, Plan 13831
74.	3727 Victory St.	Lot A, DL 150, Grp 1, Plan 13831
75.	3735 Victory St.	Lot B, Blk 1, DL 150, Grp 1, Plan 13831
76.	3738 Victory St.	Lot O, DL 150, Grp 1, Plan 13831
77.	3745 Victory St.	Lot C, Blk 1, DL 150, Grp 1, Plan 13831
78.	3746 Victory St.	Lot N, DL 150, Grp 1, Plan 13831
79.	3755 Victory St.	Lot D, DL 150, Grp 1, Plan 13831
80.	3756 Victory St.	Lot M, DL 150, Grp 1, Plan 13831
81.	3765 Victory St.	Lot E, Blk 1, DL 150, Grp 1, Plan 13831
82.	3766 Victory St.	Lot L, DL 150, Grp 1, Plan 13831
83.	3775 Victory St.	Lot F, Blk 1, DL 150, Grp 1, Plan 13831
84.	3776 Victory St.	Lot K, DL 150, Grp 1, Plan 13831
85.	3785 Victory St.	Lot G, Blk 1, DL 150, Grp 1, Plan 13831
86.	3786 Victory St.	Lot J, DL 150, Grp 1, Plan 13831
87.	3795 Victory St.	Lot H, DL 150, Grp 1, Plan 13831
88.	3796 Victory St.	Lot I, Blk 3, DL 150, Grp 1, Plan 13831
89.	3725 Arbor St.	Lot A, DL 150, Grp 1, Plan 13693
90.	3726 Arbor St.	Lot S, DL 150, Grp 1, Plan 13693
91.	3735 Arbor St.	Lot B, DL 150, Grp 1, Plan 13693
92.	3736 Arbor St.	Lot R, DL 150, Grp 1, Plan 13693
93.	3745 Arbor St.	Lot C, DL 150, Grp 1, Plan 13693
94.	3746 Arbor St.	Lot Q, DL 150, Grp 1, Plan 13693
95.	3755 Arbor St.	Lot D, Blk 3, DL 150, Grp 1, Plan 13693
96.	3756 Arbor St.	Lot P, DL 150, Grp 1, Plan 13693
97.	3765 Arbor St.	Lot E, DL 150, Grp 1, Plan 13693
98.	3766 Arbor St.	Lot O, DL 150, Grp 1, Plan 13693
99.	3775 Arbor St.	Lot F, DL 150, Grp 1, Plan 13693
100.	3776 Arbor St.	Lot N, DL 150, Grp 1, Plan 13693
101.	3785 Arbor St.	Lot G, DL 150, Grp 1, Plan 13693

Rezoning Reference #1/96
 Schedule "A" Page 3

102.	3786 Arbor St.	Lot M, DL 150, Grp 1, Plan 13693
103.	3795 Arbor St.	Lot H, DL 150, Grp 1, Plan 13693
104.	3796 Arbor St.	Lot L, DL 150, Grp 1, Plan 13693
105.	3725 Watling St.	Lot D, DL 150, Grp 1, Plan 13388
106.	3726 Watling St.	Lot S, DL 150, Grp 1, Plan 13388
107.	3735 Watling St.	Lot E, DL 150, Grp 1, Plan 13388
108.	3736 Watling St.	Lot R, DL 150, Grp 1, Plan 13388
109.	3745 Watling St.	Lot F, DL 150, Grp 1, Plan 13388
110.	3746 Watling St.	Lot Q, DL 150, Grp 1, Plan 13388
111.	3755 Watling St.	Lot G, DL 150, Grp 1, Plan 13388
112.	3756 Watling St.	Lot P, DL 150, Grp 1, Plan 13388
113.	3765 Watling St.	Lot H, DL 150, Grp 1, Plan 13388
114.	3766 Watling St.	Lot O, DL 150, Grp 1, Plan 13388
115.	3775 Watling St.	Lot I, DL 150, Grp 1, Plan 13388
116.	3776 Watling St.	Lot N, DL 150, Grp 1, Plan 13388
117.	3785 Watling St.	Lot J, DL 150, Grp 1, Plan 13388
118.	3786 Watling St.	Lot M, DL 150, Grp 1, Plan 13388
119.	3795 Watling St.	Lot K, DL 150, Grp 1, Plan 13388
120.	3796 Watling St.	Lot L, DL 150, Grp 1, Plan 13388
121.	3726 Irmin St.	Lot F, Blk 18, DL 150, Grp 1, Plan 13211
122.	3727 Irmin St.	Lot D, Blk 11, DL 150, Grp 1, Plan 13211
123.	3735 Irmin St.	Lot E, Blk 11, DL 150, Grp 1, Plan 13211
124.	3736 Irmin St.	Lot G, Blk 18, DL 150, Grp 1, Plan 13211
125.	3745 Irmin St.	Lot F, Blk 11, DL 150, Grp 1, Plan 13211
126.	3746 Irmin St.	Lot H, Blk 18, DL 150, Grp 1, Plan 13211
127.	3755 Irmin St.	Lot G, Blk 11, DL 150, Grp 1, Plan 13211
128.	3756 Irmin St.	Lot I, Blk 18, DL 150, Grp 1, Plan 13211
129.	3765 Irmin St.	Lot H, Blk 11, DL 150, Grp 1, Plan 13211
130.	3766 Irmin St.	Lot J, Blk 18, DL 150, Grp 1, Plan 13211
131.	3775 Irmin St.	Lot I, Blk 11, DL 150, Grp 1, Plan 13211
132.	3776 Irmin St.	Lot K, Blk 18, DL 150, Grp 1, Plan 13211
133.	3785 Irmin St.	Lot J, Blk 11, DL 150, Grp 1, Plan 13211
134.	3786 Irmin St.	Lot L, Blk 18, DL 150, Grp 1, Plan 13211
135.	3795 Irmin St.	Lot K, Blk 11, DL 150, Grp 1, Plan 13211
136.	3796 Irmin St.	Lot M, Blk 18, DL 150, Grp 1, Plan 13211
137.	4010 Irmin St.	Parcel C (EP14393) of Lots 1 and 2, DL 150, Grp 1, Plan 15154
138.	4018 Irmin St.	Lot 2 except: the westerly 1 foot shown on EP14393, DL 150, Grp 1, Plan 15154
139.	4032 Irmin St.	Lot 3, DL 150, Grp 1, Plan 15154
140.	4040 Irmin St.	Lot 4, DL 150, Grp 1, Plan 15154
141.	4050 Irmin St.	Lot 5, DL 150, Grp 1, Plan 15154
142.	4060 Irmin St.	Lot A except: firstly: part subdivided by plan 15154 and secondly: parcel D and lane as shown on EP14617; DL 150, Grp 1, Plan 3372
143.	4070 Irmin St.	Lot 1, DL 150, Grp 1, Plan 22096
144.	4080 Irmin St.	Lot 31, DL 150, Grp 1, Plan 26140
145.	3721 Rumble St.	Lot 5, Blk 18, DL 150, Grp 1, Plan 2041
146.	3739 Rumble St.	Lot N, Blk 18, DL 150, Grp 1, Plan 13211
147.	3749 Rumble St.	Lot O, Blk 18, DL 150, Grp 1, Plan 13211
148.	3757 Rumble St.	Lot P, Blk 18, DL 150, Grp 1, Plan 13211
149.	3765 Rumble St.	Lot Q, Blk 18, DL 150, Grp 1, Plan 13211
150.	3775 Rumble St.	Lot R, Blk 18, DL 150, Grp 1, Plan 13211
151.	3783 Rumble St.	Lot S, Blk 18, DL 150, Grp 1, Plan 13211

152.	3793 Rumble St.	Lot T, Blk 18, DL 150, Grp 1, Plan 13211
153.	4005 Rumble St.	Lot 1, DL 150, Grp 1, Plan 10119
154.	4015 Rumble St.	Lot 2, DL 150, Grp 1, Plan 10119
155.	4025 Rumble St.	Lot 3, DL 150, Grp 1, Plan 10119
156.	4039 Rumble St.	Lot 4, DL 150, Grp 1, Plan 10119
157.	4045 Rumble St.	Lot 5, DL 150, Grp 1, Plan 10119
158.	4055 Rumble St.	Lot 6, DL 150, Grp 1, Plan 10119
159.	4065 Rumble St.	Lot 7, DL 150, Grp 1, Plan 10119
160.	4075 Rumble St.	Lot 11, Blk 15, DL 150, Grp 1, Plan 2042
161.	4085 Rumble St.	Lot 10, Blk 15, DL 150, Grp 1, Plan 2042
162.	4095 Rumble St.	Lot 9, Blk 15, DL 150, Grp 1, Plan 2042
163.	6830 Boundary Rd.	Lot 19, DL 150, Grp 1, Plan 2256
164.	6840 Boundary Rd.	Lot 20, DL 150, Grp 1, Plan 2256
165.	6910 Boundary Rd.	Lot 1, DL 150, Grp 1, Plan 19802
166.	6920 Boundary Rd.	Lot 2, DL 150, Grp 1, Plan 19802
167.	6940 Boundary Rd.	Lot 1, DL 150, Grp 1, Plan 23738
168.	7024 Boundary Rd.	Lot 34, DL 150, Grp 1, Plan 28927
169.	7040 Boundary Rd.	Lot 35, DL 150, Grp 1, Plan 28927
170.	7070 Boundary Rd.	Lot B, DL 150, Grp 1, Plan 14473
171.	7110 Boundary Rd.	Lot 1, Blk 1, DL 150, Grp 1, Plan 2041
172.	7120 Boundary Rd.	Lot 2, Blk 1, DL 150, Grp 1, Plan 2041
173.	7130 Boundary Rd.	Lot 3, Blk 1, DL 150, Grp 1, Plan 2041
174.	7228 Boundary Rd.	Lot 2, Blk 3, DL 150, Grp 1, Plan 2041
175.	7230 Boundary Rd.	Lot 3, Blk 3, DL 150, Grp 1, Plan 2041
176.	7240 Boundary Rd.	Lot 4, Blk 3, DL 150, Grp 1, Plan 2041
177.	7310 Boundary Rd.	Lot U, DL 150, Grp 1, Plan 13693
178.	7330 Boundary Rd.	Lot T, DL 150, Grp 1, Plan 13693
179.	7350 Boundary Rd.	Lot C, Blk 10, DL 150, Grp 1, Plan 13388
180.	7370 Boundary Rd.	Lot B, DL 150, Grp 1, Plan 13388
181.	7390 Boundary Rd.	Lot A, DL 150, Grp 1, Plan 13388
182.	7410 Boundary Rd.	Lot U, DL 150, Grp 1, Plan 13388
183.	7430 Boundary Rd.	Lot T, DL 150, Grp 1, Plan 13388
184.	7450 Boundary Rd.	Lot C, Blk 11, DL 150, Grp 1, Plan 13211
185.	7470 Boundary Rd.	Lot B, Blk 11, DL 150, Grp 1, Plan 13211
186.	7490 Boundary Rd.	Lot A, Blk 11, DL 150, Grp 1, Plan 13211
187.	7510 Boundary Rd.	Lot E, Blk 18, DL 150, Grp 1, Plan 13211
188.	7530 Boundary Rd.	Lot D, Blk 18, DL 150, Grp 1, Plan 13211
189.	7550 Boundary Rd.	Lot C, Blk 18, DL 150, Grp 1, Plan 13211
190.	7570 Boundary Rd.	Lot B, Blk 18, DL 150, Grp 1, Plan 13211
191.	7590 Boundary Rd.	Lot A, Blk 18, DL 150, Grp 1, Plan 13211
192.	6876 Joffre Ave.	Lot 10, DL 150, Grp 1, Plan 15981
193.	6912 Joffre Ave.	Lot 35, DL 150, Grp 1, Plan 15420
194.	6959 Joffre Ave.	Lot F, Blk C, DL 150, Grp 1, Plan 15057
195.	6863 Mandy Ave.	Lot 3, DL 150, Grp 1, Plan 15981
196.	6883 Mandy Ave.	Parcel 2, (EP14584) Blk E, DL 150, Grp 1, Plan 4053
197.	6925 Mandy Ave.	Lot 52 except: part shown on EP16796 of Lot A, DL 150, Grp 1, Plan 15609
198.	6955 Mandy Ave.	The south 50 feet (EP16796) of Lot 52, DL 150, Grp 1, Plan 15609
199.	7525 Patterson Ave.	Lot 32, DL 150, Grp 1, Plan 26140