

CITY OF BURNABY

BYLAW NO. 10333

A BYLAW to amend Bylaw No. 4742, being
Burnaby Zoning Bylaw 1965

WHEREAS application for rezoning has been made to the Council;

AND WHEREAS the Council has held a public hearing thereon after duly giving notice of the time and place of such hearing as prescribed by Sections 956 and 957 of the Municipal Act, R.S.B.C. 1979;

NOW THEREFORE the Council of the City of Burnaby ENACTS as follows:

1. This Bylaw may be cited as BURNABY ZONING BYLAW 1965, AMENDMENT BYLAW NO. 7, 1996.
2. The Map (hereinafter called "Map 'A'"), attached to and forming an integral part of Bylaw No. 4742, being "Burnaby Zoning Bylaw 1965", and designated as the Official Zoning Map of the City of Burnaby, is hereby amended according to the Map (hereinafter called "Map 'B'"), marginally numbered R.Z. 3016, annexed to this Bylaw, and in accordance with the explanatory legend, notations, references and boundaries designated, described, delimited and specified in particularity shown upon said Map 'B'; and the various boundaries and districts shown upon said Map 'B' respectively are an amendment of and in substitution for the respective districts, designated and marked on said Map 'A' insofar as the same are changed, modified or varied thereby, and the said Map 'A' shall be deemed to be and is hereby declared to be

amended accordingly and the said Map 'B' is hereby declared to be and shall form an integral part of said Map 'A', as if originally incorporated therein and shall be interpreted accordingly.

3. The Comprehensive Development Plan entitled "PROPOSED ST. HELEN'S CHURCH" prepared by L.O. LUND & ASSOCIATES ARCHITECTS and on file in the office of the Director Planning and Building, is deemed to be attached to and form part of this Bylaw and any development on the lands rezoned by this Bylaw shall be in conformity with the said Comprehensive Development Plan.

Read a first time this	5 th	day of	FEBRUARY	1996
Read a second time this	4 th	day of	MARCH	1996
Read a third time	9 th	day of	SEPTEMBER	1996
Reconsidered and adopted this	21 st	day of	OCTOBER	1996

ACTING MAYOR

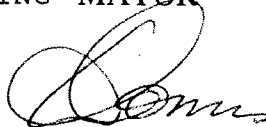
CLERK

**BYLAW NUMBER 10333 BEING A BYLAW TO AMEND
BYLAW NUMBER 4742 BEING THE BURNABY ZONING BYLAW 1965**

PROPERTY REZONED TO:

CD COMPREHENSIVE DEVELOPMENT DISTRICT (BASED ON P1 NEIGHBOURHOOD INSTITUTIONAL DISTRICT GUIDELINES AND IN ACCORDANCE WITH THE DEVELOPMENT PLAN ENTITLED "PROPOSED ST. HELEN'S CHURCH" PREPARED BY .L.O. LUND & ASSOCIATES ARCHITECTS

LEGAL: West Half Lot B, East Half Lot B, D.L. 186, Group 1, NWD Plan 6572, Lot 48, D.L. 186, Plan 59942, Lot 16, Block 7, D.L. 186, Group 1, NWD Plan 1124

MAP "B"

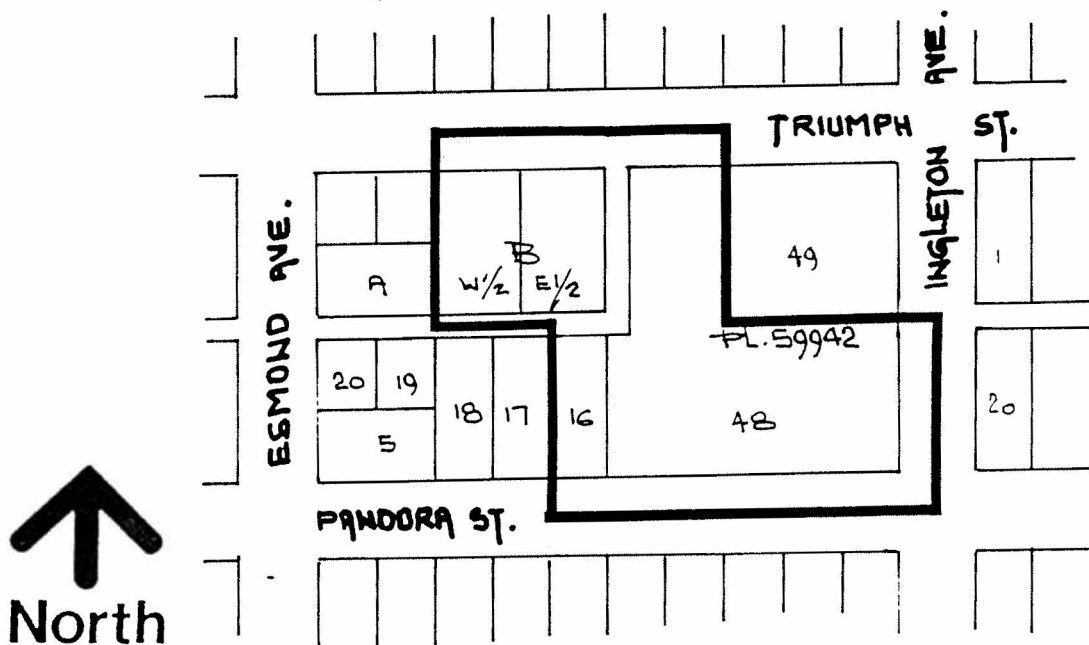

THE AREA(S) SHOWN
ABOVE OUTLINED
IN BLACK (———)
IS (ARE) REZONED:

FROM: R5 RESIDENTIAL DISTRICT AND P1 NEIGHBOURHOOD INSTITUTIONAL DISTRICT

TO: CD COMPREHENSIVE DEVELOPMENT DISTRICT (BASED ON P1 NEIGHBOURHOOD INSTITUTIONAL DISTRICT GUIDELINES AND IN ACCORDANCE WITH THE DEVELOPMENT PLAN ENTITLED "PROPOSED ST. HELEN'S CHURCH" PREPARED BY L.O. LUND & ASSOCIATES ARCHITECTS

PLANNING DEPARTMENT	
SCALE	1:2000
DRAWN	J.P.C.
DATE	JANUARY 1996



OFFICIAL ZONING MAP