

CITY OF BURNABY

BYLAW NO. 10331

A BYLAW to authorize the entry into an agreement with the City of Coquitlam for the sharing of the cost of undertaking improvements to a jointly owned drainage culvert under North Road

The Council of the City of Burnaby ENACTS as follows:



1. This Bylaw may be cited as NORTH ROAD DRAINAGE WORKS COST SHARING BYLAW 1996.
2. The City of Burnaby is authorized to enter into an agreement in the form annexed hereto as Schedule "A" with the City of Coquitlam to pay one half of the costs of undertaking the works referred to in the said agreement.

Read a first time this 8th day of JANUARY 1996

Read a second time this 8th day of JANUARY 1996

Read a third time this 8th day of JANUARY 1996

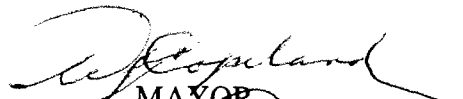
Reconsidered and adopted by an affirmative vote of at least two-thirds of all members of Council this 4th day of MARCH 1996

MAYOR

CLERK

SCHEDULE "A"

THIS AGREEMENT made as of the 4TH day of MARCH 1996.

BETWEEN:

CITY OF COQUITLAM
1111 Brunette Avenue
Coquitlam, B.C. V3K 1E9

OF THE FIRST PART

AND:

CITY OF BURNABY
4949 Canada Way
Burnaby, B.C. V5G 1M2

OF THE SECOND PART

WHEREAS:

- A. North Road is located along the north/south boundary line between Coquitlam and Burnaby;
- B. Coquitlam and Burnaby consider it to be in their mutual interests to upgrade or replace the jointly owned drainage culvert under North Road at the location shown on the sketch plan attached hereto as Schedule "B" (the "Works");
- C. The cost of the Works is expected to be approximately \$100,000 and Coquitlam has issued an invitation for tenders to undertake the Works;

NOW THEREFORE THIS AGREEMENT WITNESSES THAT, in consideration of the terms, covenants and agreements herein contained and other good and valuable consideration (the receipt and sufficiency of which is hereby acknowledged and agreed to by the parties), the parties hereto hereby covenant and agree as follows:

1. Coquitlam will carry out the design of the Works, the contracting out of the construction of the Works and the administration of the construction contract.
2. The cost of constructing the Works will be shared equally between Coquitlam and Burnaby.
3. Coquitlam and Burnaby agree to cooperate fully, the one with the other, to execute all such documents and do all such things as required in order to more fully perfect the intention of this Agreement.
4. Burnaby hereby grants to Coquitlam, its respective contractors, subcontractors, employees, agents and officials the right to enter, labour, pass, repass, work and be in, on, under and over Burnaby's property with or without vehicles, tools, supplies, materials and equipment and supplies for any purpose connected with the construction of the Works.

IN WITNESS WHEREOF the parties hereto have executed this Agreement as of the day and year first above written.

THE CORPORATE SEAL OF THE CITY OF
COQUITLAM WAS HEREUNTO AFFIXED
IN THE PRESENCE OF:

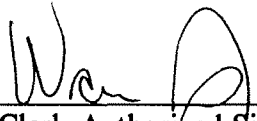

City Clerk-Authorized Signatory
Warren Jones
City Clerk



Mayor Louis Sekora - Mayor

THE CORPORATE SEAL OF THE CITY
OF BURNABY WAS HEREUNTO AFFIXED
IN THE PRESENCE OF:



City Clerk-Authorized Signatory

Schedule "B"

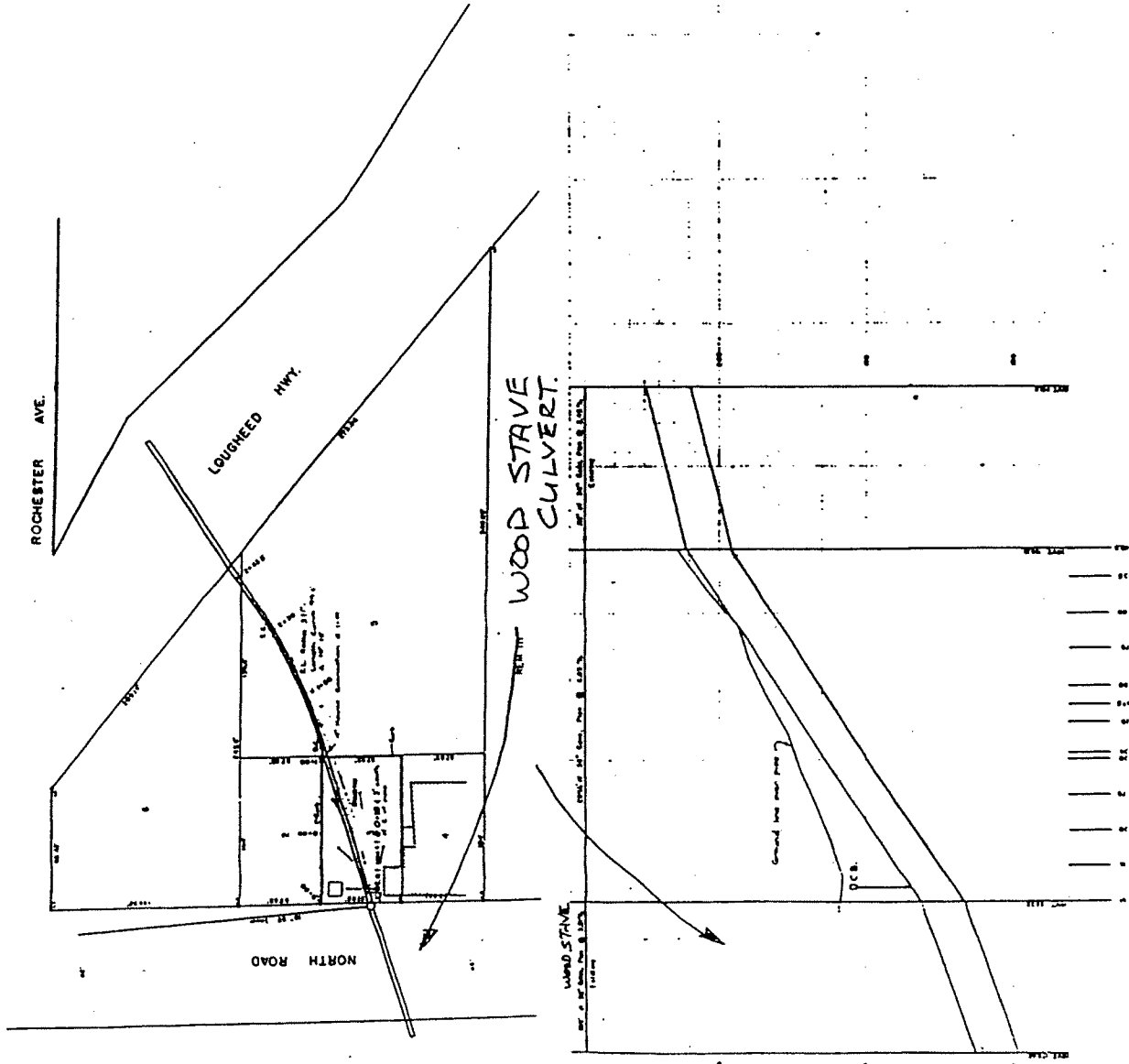

1. The sewer shown on this plan is to be constructed in accordance with the specifications for storm sewers set out in the Standard Specifications for Public Works, 1917, and the amendments thereto, and the following notes:

1. The sewer to be constructed is of 18" diameter.
2. The sewer to be constructed is of wood stave construction.
3. The sewer to be constructed is to be laid on a grade of 1:100.
4. The sewer to be constructed is to be laid on a bed of 4" of sand.
5. The sewer to be constructed is to be laid on a bed of 4" of sand.
6. The sewer to be constructed is to be laid on a bed of 4" of sand.
7. The sewer to be constructed is to be laid on a bed of 4" of sand.
8. The sewer to be constructed is to be laid on a bed of 4" of sand.
9. The sewer to be constructed is to be laid on a bed of 4" of sand.
10. The sewer to be constructed is to be laid on a bed of 4" of sand.
11. The sewer to be constructed is to be laid on a bed of 4" of sand.
12. The sewer to be constructed is to be laid on a bed of 4" of sand.
13. The sewer to be constructed is to be laid on a bed of 4" of sand.
14. The sewer to be constructed is to be laid on a bed of 4" of sand.
15. The sewer to be constructed is to be laid on a bed of 4" of sand.
16. The sewer to be constructed is to be laid on a bed of 4" of sand.
17. The sewer to be constructed is to be laid on a bed of 4" of sand.
18. The sewer to be constructed is to be laid on a bed of 4" of sand.
19. The sewer to be constructed is to be laid on a bed of 4" of sand.
20. The sewer to be constructed is to be laid on a bed of 4" of sand.

LM.1

D-105

THE CORPORATION OF THE DISTRICT OF COQUITLAN		STORM SEWER	
BETWEEN NORTH ROAD AND LOUGHEED HWY. AT ROCHESTER AVE.		PLAN	
Scale	1" = 10'	Sheet No.	D-105
Drawn by	W. H. P. Co.	Checked by	
Approved by		Engineer	