

CITY OF BURNABY

BYLAW NO. 10296

A BYLAW to amend Bylaw No. 4742, being
Burnaby Zoning Bylaw 1965

WHEREAS application for rezoning has been made to the Council;

AND WHEREAS the Council has held a public hearing thereon after duly giving notice of the hearing as prescribed by sections 956 and 957 of the Municipal Act R.S.B.C. 1979;

NOW THEREFORE the Council of the City of Burnaby ENACTS as follows:

1. This Bylaw may be cited as BURNABY ZONING BYLAW 1965, AMENDMENT BYLAW NO. 46, 1995.
2. The map (hereinafter called "Map 'A'") attached to and forming an integral part of Bylaw No. 4742, being Burnaby Zoning Bylaw 1965, and designated as the Official Zoning Map of the City of Burnaby, is hereby amended according to the Map (hereinafter called "Maps 'B'"), marginally numbered R.Z. 3006 annexed to this Bylaw, and in accordance with the explanatory legend, notations, references and boundaries designated, described, delimited and specified in particularity shown upon said Maps 'B', and the various boundaries and districts shown upon said Maps 'B', respectively are an amendment of and in substitution for the respective districts, designated and marked on said Map 'A' insofar as the same are changed, modified or varied thereby, and the said Map 'A' shall be deemed to be and is hereby declared to be amended accordingly and the said Map 'B' is hereby declared to be and shall form an

integral part of said Map 'A' as if originally incorporated therein and shall be interpreted accordingly.



Read a first time this 2nd day of OCTOBER 1995

Read a second time this 6th day of NOVEMBER 1995

Read a third time this 20th day of NOVEMBER 1995

Received the approval of the Minister of Transportation and Highways
this 30th day of NOVEMBER 1995

Reconsidered and adopted this 22nd day of JANUARY 1996

MAYOR

CLERK

**BYLAW NUMBER 10296 BEING A BYLAW TO AMEND
BYLAW NUMBER 4742 BEING THE BURNABY ZONING BYLAW 1965**

PROPERTY REZONED TO:

P2 ADMINISTRATION & ASSEMBLY DISTRICT

LEGAL: PTN. LOT 312, D.L. 56 & 57, GROUP 1, NWD PLAN 66423

MAP "B"

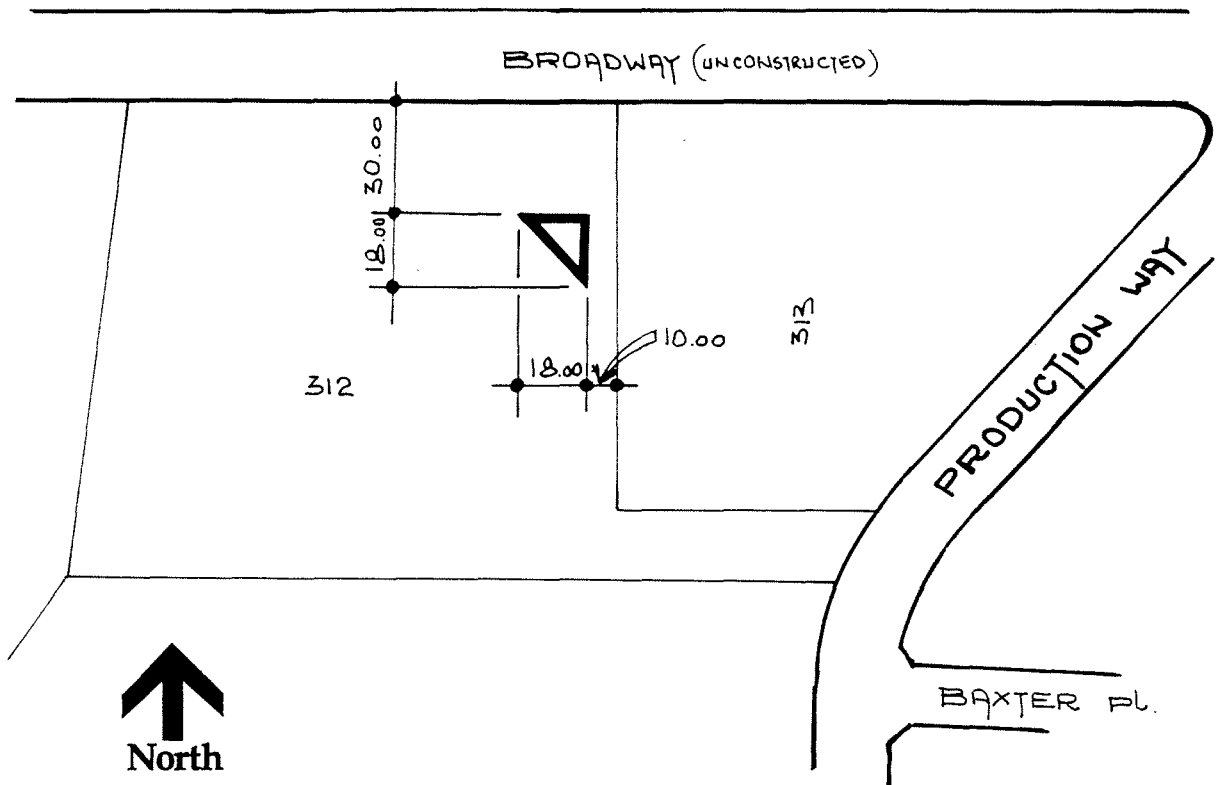

**THE AREA(S) SHOWN
ABOVE OUTLINED
IN BLACK (—)
IS (ARE) REZONED:**

FROM: M3 HEAVY INDUSTRIAL DISTRICT

TO: P2 ADMINISTRATION & ASSEMBLY DISTRICT

PLANNING DEPARTMENT	
SCALE	1:2000
DRAWN	J.P.C.
DATE	SEPT. 1995



OFFICIAL ZONING MAP

No. RZ 3006