

CITY OF BURNABY

BYLAW NO. 10113

A BYLAW to amend Bylaw No. 4742, being
Burnaby Zoning Bylaw 1965

WHEREAS application for rezoning has been made to the Council;

AND WHEREAS the Council has held a public hearing thereon after duly giving notice of the time and place of such hearing as prescribed by Sections 956 and 957 of the Municipal Act, R.S.B.C. 1979;

NOW THEREFORE the Council of the City of Burnaby ENACTS as follows:

1. This Bylaw may be cited as BURNABY ZONING BYLAW 1965, AMENDMENT BYLAW NO. 40, 1994.
2. The Map (hereinafter called "Map 'A'"), attached to and forming an integral part of Bylaw No. 4742, being "Burnaby Zoning Bylaw 1965", and designated as the Official Zoning Map of the City of Burnaby, is hereby amended according to the Map (hereinafter called "Map 'B'"), marginally numbered R.Z. 2050, annexed to this Bylaw, and in accordance with the explanatory legend, notations, references and boundaries designated, described, delimited and specified in particularity shown upon said Map 'B'; and the various boundaries and districts shown upon said Map 'B' respectively are an amendment of and in substitution for the respective districts, designated and marked on said Map 'A' insofar as the same are changed, modified or varied thereby, and the said Map 'A' shall be deemed to be and is hereby declared to be

amended accordingly and the said Map 'B' is hereby declared to be and shall form an integral part of said Map 'A', as if originally incorporated therein and shall be interpreted accordingly.

3. The Comprehensive Development Plan entitled TOWNHOUSE DEVELOPMENT, EDMONDS & SALISBURY, BURNABY, B.C." prepared by ROGER ROMSES ARCHITECTS and on file in the office of the Director Planning and Building, is deemed to be attached to and form part of this Bylaw and any development on the lands rezoned by this Bylaw shall be in conformity with the said Comprehensive Development Plan.

Read a first time this 6th day of SEPTEMBER 1994

Read a second time this 3rd day of OCTOBER 1994

Read a third time this 19th day of DECEMBER 1994

RECONSIDERED AND ADOPTED THIS 20th day MARCH 1995

MAYOR

CLERK

BYLAW NUMBER 10,113 BEING A BYLAW TO AMEND BYLAW NUMBER 4742 BEING THE BURNABY ZONING BYLAW 1965

PROPERTY REZONED TO:

MAP "B"

CD COMPREHENSIVE DEVELOPMENT DISTRICT (BASED ON RM2 MULTIPLE FAMILY RESIDENTIAL DISTRICT USE AND DENSITY AND IN ACCORDANCE WITH THE DEVELOPMENT PLAN ENTITLED "TOWNHOUSE DEVELOPMENT, EDMONDS & SALISBURY, BURNABY, B.C." PREPARED BY ROGER ROMSES ARCHITECTS)

LEGAL: LOTS A, B AND C, D.L. 95, GROUP 1, N.W.D. PLAN 4067; PARCEL C (REF. PLAN 6286) OF LOT 1, D.L. 95, GROUP 1, N.W.D. PLAN 3702; PTN. PARCEL B (REF. PLAN 6347) OF LOT 1, D.L. 95, GROUP 1, N.W.D. PLAN 3702; PARCEL A (REF. PLAN 7028) OF LOT 1, D.L. 95, GROUP 1, N.W.D. PLAN 1152; PTN. PARCEL C, D.L. 95, GROUP 1, N.W.D. PLAN 52453; LOT 167, D.L. 95, GROUP 1, N.W.D. PLAN 30087

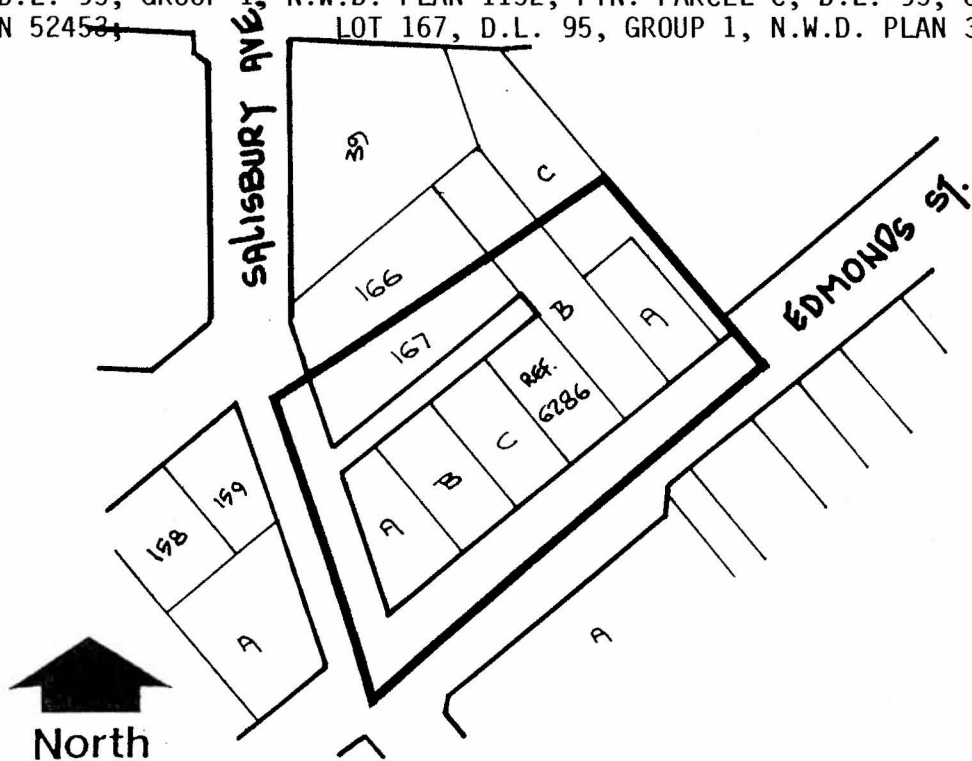

**THE AREA(S) SHOWN
ABOVE OUTLINED
IN BLACK (———)
IS (ARE) REZONED:**

FROM: R5 RESIDENTIAL DISTRICT

TO: CD COMPREHENSIVE DEVELOPMENT DISTRICT (BASED ON RM2 MULTIPLE FAMILY RESIDENTIAL DISTRICT USE AND DENSITY, AND IN ACCORDANCE WITH THE DEVELOPMENT PLAN ENTITLED "TOWNHOUSE DEVELOPMENT, EDMONDS & SALISBURY, BURNABY, B.C." PREPARED BY ROGER ROMSES ARCHITECTS)

**PLANNING
DEPARTMENT**

SCALE	1:2000
DRAWN	J.P.C.
DATE	AUGUST 1994



OFFICIAL ZONING MAP

No. RZ 2050