

CITY OF BURNABY

BYLAW NO. 10018

A BYLAW to amend Bylaw No. 4742, being
Burnaby Zoning Bylaw 1965

WHEREAS application for rezoning has been made to the Council;

AND WHEREAS the Council has held a public hearing thereon after duly giving notice of the hearing as prescribed by sections 956 and 957 of the Municipal Act R.S.B.C. 1979;

NOW THEREFORE the Council of the City of Burnaby ENACTS as follows:

1. This Bylaw may be cited as BURNABY ZONING BYLAW 1965, AMENDMENT BYLAW NO. 8, 1994.
2. The map (hereinafter called "Map 'A'") attached to and forming an integral part of Bylaw No. 4742, being Burnaby Zoning Bylaw 1965, and designated as the Official Zoning Map of the City of Burnaby, is hereby amended according to the Map (hereinafter called "Maps 'B'"), marginally numbered R.Z. 2021 annexed to this Bylaw, and in accordance with the explanatory legend, notations, references and boundaries designated, described, delimited and specified in particularity shown upon said Maps 'B', and the various boundaries and districts shown upon said Maps 'B', respectively are an amendment of and in substitution for the respective districts, designated and marked on said Map 'A' insofar as the same are changed, modified or varied thereby, and the said Map 'A' shall be deemed to be and is hereby declared to be amended accordingly and the said Map 'B' is hereby declared to be and shall form an



integral part of said Map 'A' as if originally incorporated therein and shall be interpreted accordingly.

Read a first time this 28th day of February 1994

Read a second time this 22nd day of March 1994

Read a third time this 12th day of August 2002

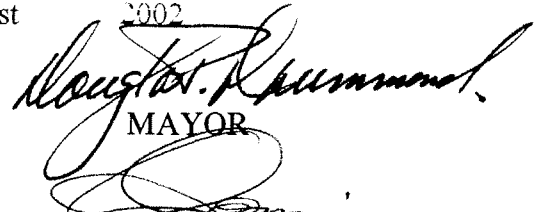
Reconsidered and adopted this 12th day of August 2002

MAYOR

CLERK

BYLAW NUMBER 10,018 BEING A BYLAW TO AMEND BYLAW NUMBER 4742 BEING THE BURNABY ZONING BYLAW 1965

PROPERTY REZONED TO:

P2 ADMINISTRATION AND ASSEMBLY DISTRICT

MAP "B"

LEGAL: LOTS 25 AND 26, D.L. 98, GROUP 1, N.W.D. PLAN 1384

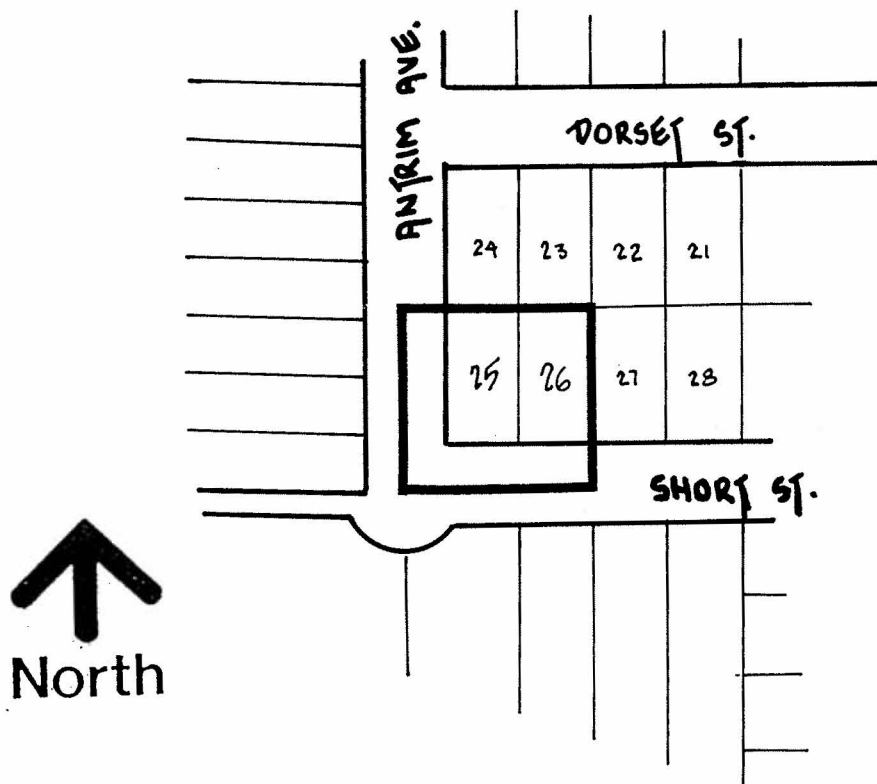

THE AREA(S) SHOWN
ABOVE OUTLINED
IN BLACK (——)
IS (ARE) REZONED:

FROM: M4 SPECIAL INDUSTRIAL DISTRICT

TO: P2 ADMINISTRATION AND ASSEMBLY DISTRICT

PLANNING
DEPARTMENT

SCALE 1:2000

DRAWN A.P.C.

DATE FEBRUARY 1994



City of
Burnaby

OFFICIAL ZONING MAP

No. RZ 2021