

**CITY OF BURNABY**

**BYLAW NO. 12979**

A BYLAW to close and remove the dedication of  
a certain portion of highway

WHEREAS pursuant to section 40 of the *Community Charter* and section 120 of the *Land Title Act* the Council may by bylaw close part of a highway to traffic and remove the dedication of that part of the highway;

AND WHEREAS the Council, before adopting this Bylaw, has caused the required statutory public notice of its intention to be given by advertisement;

AND WHEREAS the Council deems it expedient and in the public interest to stop up and close to traffic and remove the dedication of that portion of highway more particularly hereinafter described;

NOW THEREFORE the Council of the City of Burnaby ENACTS as follows:

1. This Bylaw may be cited as **BURNABY HIGHWAY CLOSURE BYLAW NO. 4, 2011.**
2. ALL AND SINGULAR that certain parcel or tract of land, situate, lying and being in the City of Burnaby, in the Province of British Columbia, more particularly known and described as all that portion of road in District Lot 173, Group 1, New Westminster District, dedicated by Plan 1034 containing 0.109ha (hereinafter called "the closed portion of road") shown outlined and described as Parcel A on Reference Plan prepared by G.N. Holme, B.C.L.S., and deposited in the Land Title Office under Number BCP \_\_\_\_\_, a copy of which is hereunto annexed (hereinafter called "the plan") is hereby closed to all types of traffic.

3. The dedication of the closed portion of road as highway is removed.

Read a first time this 25<sup>th</sup> day of July 2011

Read a second time this 25<sup>th</sup> day of July 2011

Read a third time this 25<sup>th</sup> day of July 2011

Reconsidered and adopted this 12<sup>th</sup> day of September 2011

  
MAYOR

  
A/CLERK

REFERENCE PLAN TO ACCOMPANY THE CITY OF BURNABY BYLAW NO. \_\_\_\_\_ TO REMOVE THE ROAD DEDICATION OF PART OF ROAD DEDICATED BY PLAN 1034, DL 173, Gp 1, NWD Pursuant to Section 120, Land Title Act, and Section 40 of The Community Charter.

B.C.G.S. 92G.025

Scale 1 : 750



- Legend:
- ⊙ denotes control monument found
  - denotes standard iron post found
  - denotes lead plug found
  - denotes standard iron post placed.
  - NTS denotes not to scale.

Integrated Survey Area No. 25, Burnaby, NAD'83 (CSRS). All distances are in metres. Grid bearings are derived from observations between geodetic control monuments BSH6029 and 6088. This plan shows horizontal ground-level distances except where otherwise noted. To compute grid distances, multiply ground-level distances by combined factor of 0.9995980.

PLAN BCP

Deposited in the Land Title Office of New Westminster, B.C., this day of \_\_\_\_\_, 2011.

Registrar

L.T.O. Ref. No. \_\_\_\_\_

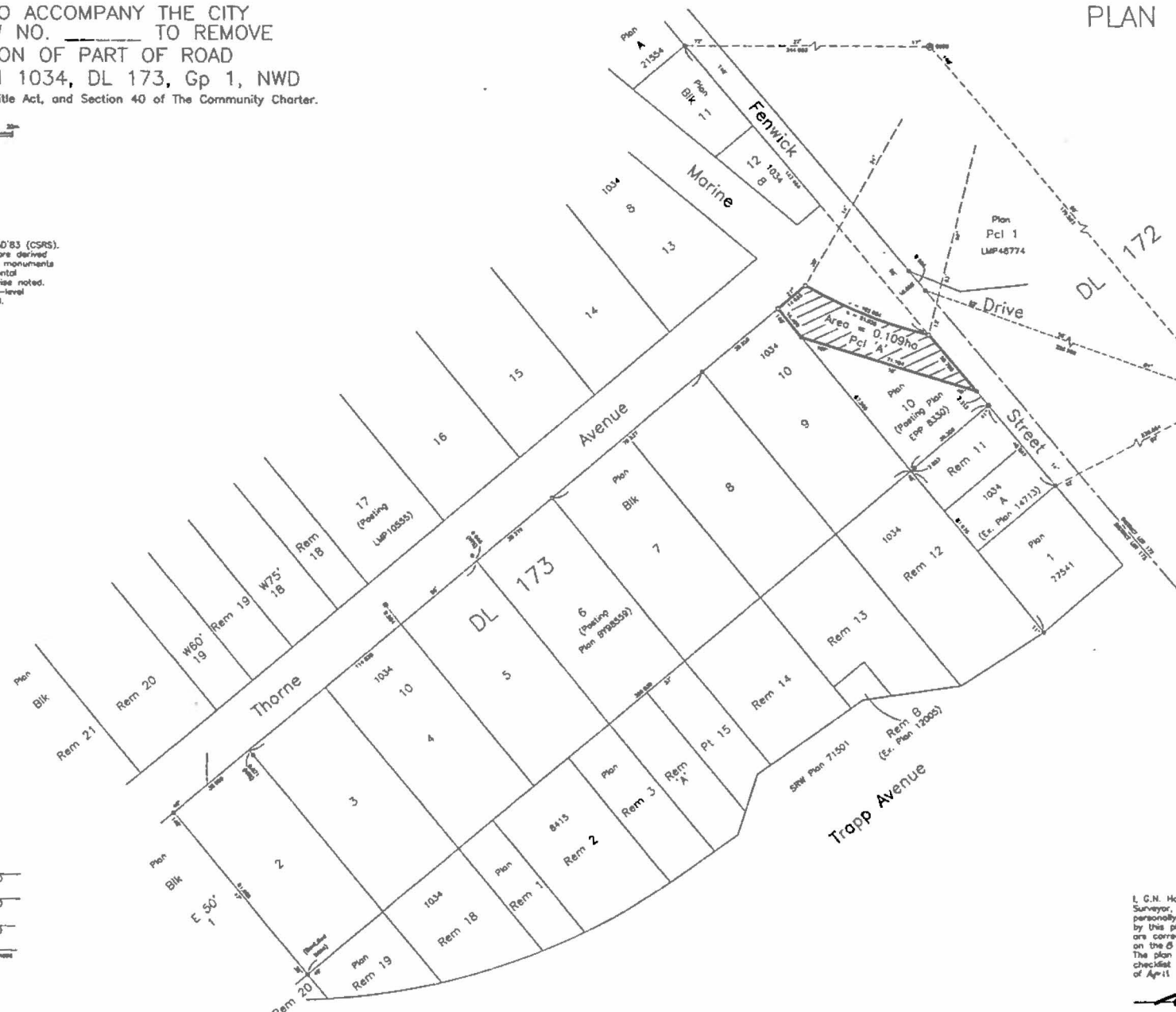

The City of Burnaby

Authorised Signatory	(Printed Name)
Authorised Signatory	(Printed Name)
Witness as to above signatures	(Printed Name)
Address of Witness	Occupation of Witness

The City of Burnaby  
 Planning Dept., Survey Section  
 4540 Canada Way, Burnaby, B.C.  
 V5B 1H2  
 Phone: (604) 294-7463  
 Fax: (604) 294-7423

"This plan lies within the Greater Vancouver Regional District."

I, G.N. Holmes, a British Columbia Land Surveyor, certify that I was present at and personally superintended the survey represented by this plan and that the survey and plan are correct. The field survey was completed on the 6<sup>th</sup> day of April, 2011. The plan was completed and checked, and the checklist filed under ECP#158133 on the 21<sup>st</sup> day of April, 2011.

*G.N. Holmes*  
 B.C.L.S.