

CITY OF BURNABY

BYLAW NO. 12618

A BYLAW to amend Bylaw No. 4742, being
Burnaby Zoning Bylaw 1965

WHEREAS application for rezoning has been made to the Council;

AND WHEREAS the Council has held a public hearing thereon after duly giving notice of the time and place of such hearing as prescribed by Sections 892 and 893 of the *Local Government Act*, R.S.B.C. 1996;

NOW THEREFORE the Council of the City of Burnaby ENACTS as follows:

1. This Bylaw may be cited as **BURNABY ZONING BYLAW 1965, AMENDMENT BYLAW NO. 12, 2009.**
2. The Map (hereinafter called "Map 'A'"), attached to and forming an integral part of Bylaw No. 4742, being "Burnaby Zoning Bylaw 1965", and designated as the Official Zoning Map of the City of Burnaby, is hereby amended according to the Map (hereinafter called "Map 'B'"), marginally numbered R.Z. 3739 annexed to this Bylaw, and in accordance with the explanatory legend, notations, references and boundaries designated, described, delimited and specified in particularity shown upon said Map 'B'; and the various boundaries and districts shown upon said Map 'B' respectively are an amendment of and in substitution for the respective districts, designated and marked on said Map 'A' insofar as the same are changed, modified or varied thereby, and the said Map 'A' shall be deemed to be and is hereby declared to be amended accordingly and the said Map 'B' is hereby declared to be and shall form an integral part of said Map 'A', as if originally incorporated therein and shall be interpreted accordingly.

Reconsidered and adopted this 13th day of May 2013

M. M. M. M.
A/CLERK

**BYLAW NUMBER 12618 BEING A BYLAW TO AMEND BYLAW
NUMBER 4742 BEING BURNABY ZONING BYLAW 1965**

LEGAL: Lots 11, West Half 10, East Half 10, Blk 33, D.L. 69, Group 1, NWD Plan 1321

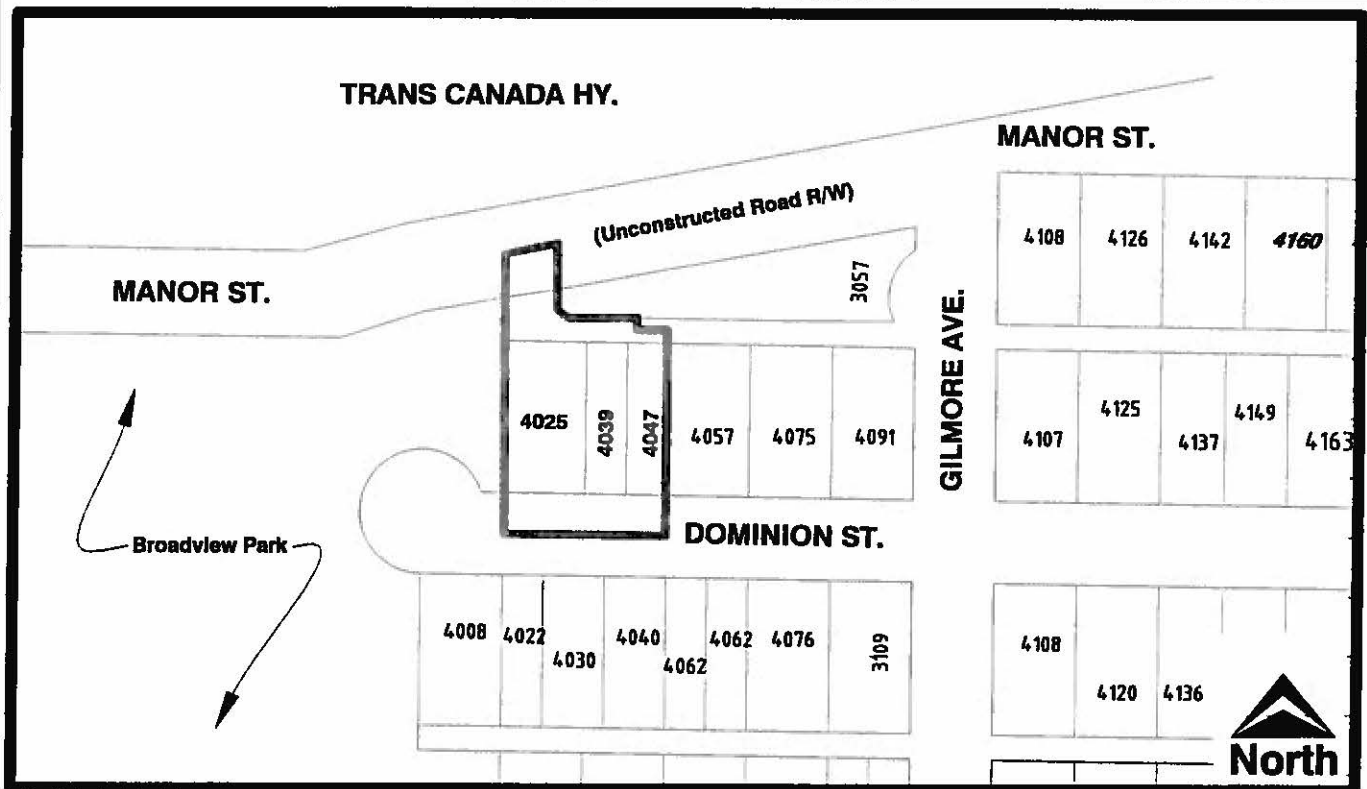

THE AREA(S) SHOWN ABOVE OUTLINED IN BLACK (==) IS (ARE) REZONED

FROM: R5 Residential District

TO: CD Comprehensive Development District (based on RM2 Multiple Family Residential District and Community Plan Eight guidelines, and in accordance with the development plan entitled "4025 Dominion Street" prepared by Matthew Cheng Architect Inc.)



Planning and Building Department

Scale: N.T.S.

Drawn By: J.P.C.

Date: April 2009

OFFICIAL ZONING MAP

Map "B"

NO.REZ. 3739