

CITY OF BURNABY

BYLAW NO. 12570

A BYLAW to amend Bylaw No. 4742, being
Burnaby Zoning Bylaw 1965

WHEREAS application for rezoning has been made to the Council;

AND WHEREAS the Council has held a public hearing thereon after duly giving notice of the hearing as prescribed by sections 892 and 893 of the *Local Government Act*, R.S.B.C. 1996;

NOW THEREFORE the Council of the City of Burnaby ENACTS as follows:

1. This Bylaw may be cited as **BURNABY ZONING BYLAW 1965, AMENDMENT BYLAW NO. 69, 2008.**

2. The map (hereinafter called "Map 'A'") attached to and forming an integral part of Bylaw No. 4742, being Burnaby Zoning Bylaw 1965, and designated as the Official Zoning Map of the City of Burnaby, is hereby amended according to the Map (hereinafter called "Map 'B'"), marginally numbered R.Z. 3725 annexed to this Bylaw, and in accordance with the explanatory legend, notations, references and boundaries designated, described, delimited and specified in particularity shown upon said Map 'B', and the various boundaries and districts shown upon said Map 'B', respectively are an amendment of and in substitution for the respective districts, designated and marked on said Map 'A' insofar as the same are changed, modified or varied thereby, and the said Map 'A' shall be deemed to be and is hereby declared to be amended accordingly and the said Map 'B' is

hereby declared to be and shall form an integral part of said Map 'A' as if originally incorporated therein and shall be interpreted accordingly.

Read a first time this 24th day of November 2008

Read a second time this 12th day of January 2009

Read a third time 19th day of January 2009

Reconsidered and adopted this 19th day of January 2009

MAYOR

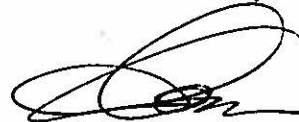
CLERK

CERTIFIED TRUE COPY
THIS 20TH DAY OF JANUARY 2009



AUTHORIZED SIGNATORY CLERK

BYLAW NUMBER 12570 BEING A BYLAW TO AMEND BYLAW NUMBER 4742 BEING BURNABY ZONING BYLAW 1965

LEGAL: See attached Schedule A

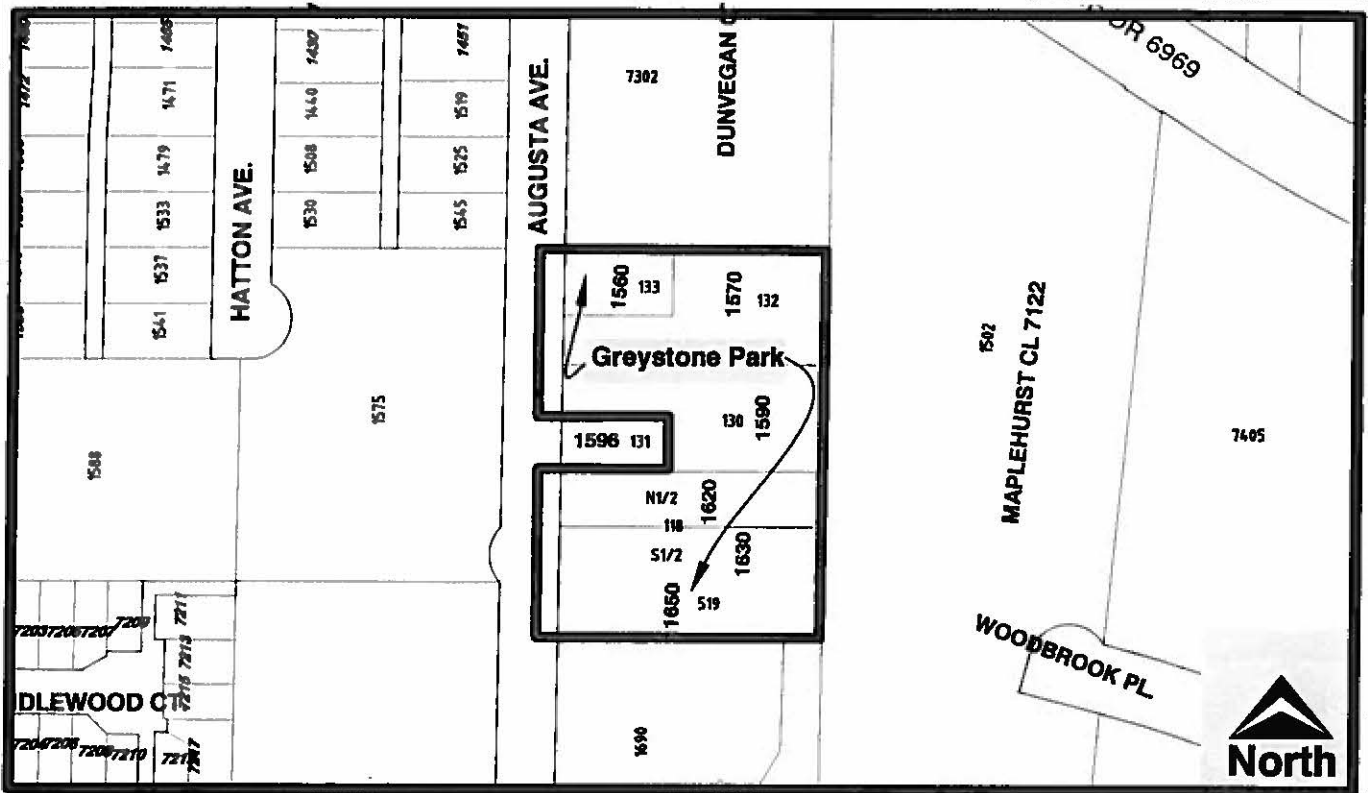

THE AREA(S) SHOWN ABOVE OUTLINED IN BLACK (—) IS (ARE) REZONED

FROM: R4 Residential District

TO: P3 Park and Public Use District



Planning and Building Department

Scale: N.T.S.

Drawn By: J.P.C.

Date: December 2008

OFFICIAL ZONING MAP

Map "B"

NO.REZ. 3725

**Rezoning Reference #08-37G
Schedule "A"**

		<u>Zoning</u>
<u>Greystone Park</u>		
1560 Augusta Avenue	- Lot 133, D.L. 135, Group 1, NWD Plan 24143	R4
1570 Augusta Avenue	- Lot 132, D.L. 135, Group 1, NWD Plan 24143	R4
1590 Augusta Avenue	- Lot 130, D.L. 135, Group 1, NWD Plan 24104	R4
1620 Augusta Avenue	- The North Half of Lot 118, DL 135, Group 1, NWD Plan 4484	R4
1630 Augusta Avenue	- The South Half of Lot 118, DL 135, Group 1, NWD Plan 4484	R4
1650 August Avenue	- Lot 519, D.L. 135, Group 1, NWD Plan 62441	R4