

CITY OF BURNABY

BYLAW NO. 12542

A BYLAW to close and remove the dedication of
certain portions of highway

WHEREAS pursuant to section 40 of the *Community Charter*, SBC 2003 and section 120 of the *Land Title Act* the Council may by bylaw close part of a highway to traffic and remove the dedication of that part of the highway;

AND WHEREAS the Council, before adopting this Bylaw, has caused the required statutory public notice of its intention to be given by advertisement;

AND WHEREAS the Council deems it expedient and in the public interest to stop up and close to traffic and remove the dedication of those portions of highway more particularly hereinafter described;

NOW THEREFORE the Council of the City of Burnaby ENACTS as follows:

1. This Bylaw may be cited as **BURNABY HIGHWAY CLOSURE BYLAW NO. 6, 2008.**
2. ALL AND SINGULAR those certain parcels or tracts of land, situate, lying and being in the City of Burnaby, in the Province of British Columbia, more particularly known and described as all those portions of road in District Lot 153, Group 1, New Westminster District:
 - (a) dedicated as road by Plan 1316 containing 29.0m², and
 - (b) dedicated as road by Plan LMP22502 containing 1322.7m²,

(hereinafter called "the closed portions of road") shown outlined and hatched and described as Pcl. A and Pcl. B on Reference Plan prepared by Hans J. Troelsen, B.C.L.S., and deposited in the Land Title Office under Number BCP _____, a copy of which is hereunto annexed is hereby closed to all types of traffic.

3. The dedication of the closed portions of road as highway is removed.

Read a first time this 27th day of October 2008

Read a second time this 27th day of October 2008

Read a third time this 27th day of October 2008

Reconsidered and adopted this 15th day of December 2008

MAYOR



CLERK

CERTIFIED TRUE COPY
THIS 16TH DAY OF DECEMBER 2008

AUTHORIZED SIGNATORY CLERK

REFERENCE PLAN TO ACCOMPANY THE CITY OF BURNABY ROAD CLOSING AND REMOVAL OF ROAD DEDICATION BYLAW No. _____ OF PORTIONS OF ROAD DEDICATED BY PLAN 1316 AND PLAN LMP22502 DISTRICT LOT 153 GROUP 1 NEW WESTMINSTER DISTRICT

BCGS 92G.026

PURSUANT TO SECTION 120 LAND TITLE ACT AND SECTION 40, COMMUNITY CHARTER

PLAN BCP _____

REF No _____

REGISTERED IN THE LAND TITLE OFFICE AT NEW WESTMINSTER, B.C. REG. DATE OF _____

REGISTRAR _____

PARTS OF ROAD CLOSED:

PARCEL A BEING PART OF ROAD DEDICATED ON PLAN 1316 DL 153 GROUP 1 NWD 29.0 m²

PARCEL B BEING PART OF ROAD DEDICATED ON PLAN LMP22502 DL 153 GROUP 1 NWD .. 1322.7 m²

TOTAL . 1351.7 m²

LEGEND

SCALE 1:250
0 5 10 15

ALL DISTANCES ARE IN METRES

- INDICATES CONTROL MONUMENT FOUND
- INDICATES STANDARD HIGH POST FOUND
- INDICATES STANDARD HIGH POST PLACED
- INDICATES LEAD FLAG FOUND
- INDICATES LEAD FLAG PLACED
- ▽ INDICATES UNREGISTERED

▨ INDICATES PORTION OF ROAD TO BE CLOSED

INTEGRATED SURVEY AREA NO. 14, CITY OF BURNABY (CPSA) DATA BEARINGS AND DISTANCES FROM OBSERVATIONS BETWEEN GEODETIC CONTROL MONUMENTS 075508 AND 034134

THIS PLAN SHOWS HORIZONTAL, VERTICAL, AND DISTANCE CORRECTIONS EXCEPT HEIGHT CORRECTIONS NOTED TO COMPUTE GRID DISTANCES. MULTIPLE GROUND-LEVEL DISTANCES BY CORRECTION FACTOR 0.999833

BEARINGS OR OFFSET POINTS ARE BY PROPERTY LINE PRODUCTION UNLESS NOTED OTHERWISE

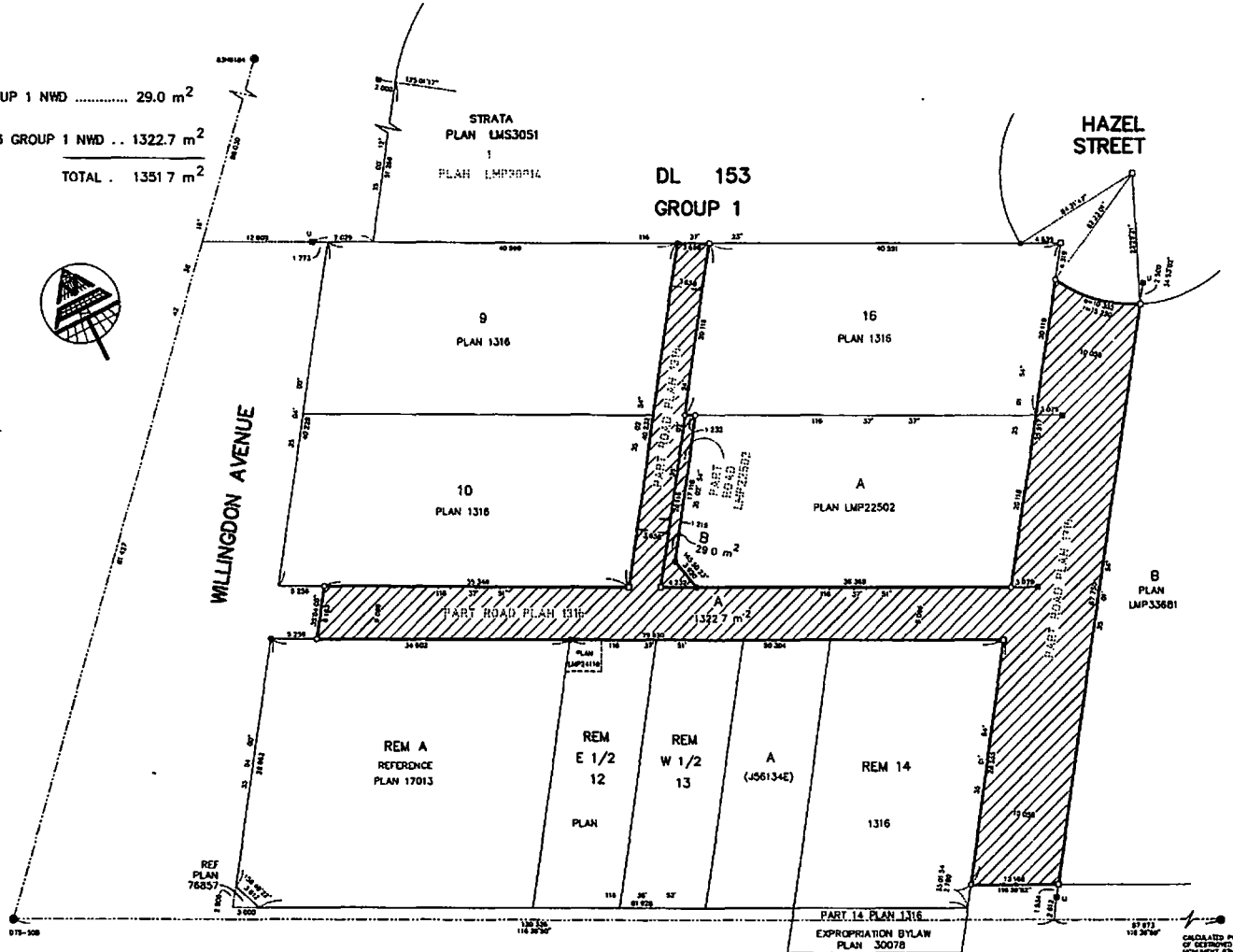

MATSON PECK & TOPLISS
SURVEYORS & ENGINEERS
2710 - 8171 CORD ROAD
RICHMOND, B.C.
V6V 2T8
PH: 604 270 9331
FAX: 604 270 4137
CADRE 19736-REF-1-RC-2 DMS

KINGSWAY

CITY OF BURNABY

SAVOR
SIGN AND PRINT NAME _____

CLERK
SIGN AND PRINT NAME _____

WITNESS AS TO SIGNATURES
SIGN AND PRINT NAME _____

OCCUPATION OF WITNESS _____

ADDRESS OF WITNESS _____

THIS PLAN LIES WITHIN THE
CREAKLE VALLEY LOCAL AREA DISTRICT

I, NAME OF WITNESS, A BRITISH COLUMBIA LAND SURVEYOR OF THE CITY OF BURNABY IN BRITISH COLUMBIA, COUNTY OF ... I HAVE PRESENT AND PERSONALLY SUPERVISED THE SURVEY REPRESENTED BY THIS PLAN, AND THAT THE SURVEY AND PLAN ARE CORRECT. THE FIELD SURVEY WAS COMPLETED ON THE 20th DAY OF SEPTEMBER 2008. THE PLAN WAS COMPLETED AND CHECKED, AND THE CHECKLIST FILED IMMEDIATELY ON THE 23rd DAY OF SEPTEMBER, 2008.

[Signature]

BCL5