

CITY OF BURNABY

BYLAW NO. 12536

A BYLAW to exempt from taxation certain lands
pursuant to sections 224(1) and (2)(c) and (f)
of the *Community Charter*

The Council of the City of Burnaby ENACTS as follows:

1. This Bylaw may be cited as **BURNABY TAXATION EXEMPTION BYLAW NO. 17, 2008.**

2. Pursuant to sections 224(1) and (2)(c) and (f) of the *Community Charter*, Council does hereby exempt from taxation under section 197(1)(a) of the said Act for the year 2009, the following lands, namely:

- (a) **SHRI GURU RAVIDASS SABHA (VANCOUVER CHAPTER)**
7271 Gilley Avenue
Roll No. 6495-7271

That portion of land occupied by Shri Guru Ravidass Sabha (Vancouver Chapter) described as follows:

ALL AND SINGULAR that certain parcel or tract of land and premises situate, lying and being in the City of Burnaby, Province of British Columbia, more particularly known and described as Lot 51, District Lot 97, Group 1, New Westminster District, Plan 34615, SAVE AND EXCEPT that portion of the improvements used for residential purposes, a proportionate area of the land as shown on plan annexed to Bylaw No. 11160, filed in the Land Title Office in New Westminster and a proportionate area of the land as shown outlined in black on the plan annexed hereto as Schedule "A".

Westminster.



- (b) **VIETNAMESE UNIFIED BUDDHIST (HOA-NGHIEM)
CONGREGATION OF B.C.**
8708 Royal Oak Avenue
Roll No. 6035-8708

That portion of land occupied by Vietnamese Unified Buddhist (Hoa-Nghiem) Congregation of B.C. described as follows:

ALL AND SINGULAR that certain parcel or tract of land and premises situate, lying and being in the Municipality of Burnaby, Province of British Columbia, more particularly known and described as Parcel 1, District Lot 162, Group 1, New Westminster District, RPPlan NWP88125.

The herein described tax-exempt parcel contains by calculation 3,384.8 square metres, and is shown outlined in green black on the plan annexed to Bylaw No.12008 filed in the Land Title Office at New Westminster.

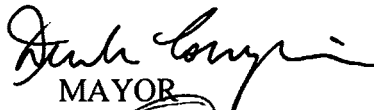
Read a first time this 29th day of September 2008
Read a second time this 29th day of September 2008
Read a third time this 29th day of September 2008
Reconsidered and adopted this 6th day of October 2008

MAYOR

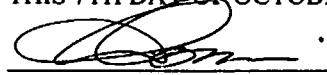
CLERK

CERTIFIED TRUE COPY
THIS 7TH DAY OF OCTOBER 2008

AUTHORIZED SIGNATORY CLERK

PLAN TO ACCOMPANY THE CITY OF
 BURNABY TAX EXEMPTION BY-LAW
 No. FOR A PORTION OF LOT 51,
 D.L.97, GP.1, N.W.D., PLAN 34615
 Pursuant to Sec 224 (2) (g) of the Community Charter Act.
 B.C.G.S. 92G.026

Scale 1 : 250



Distances are in metres and decimals thereof. Bearings are astronomic and are derived from Plan 34615. m² denotes square metres.

Civic Address:

7271 Gilley Avenue
 Burnaby, B.C.

Plan
 8
 7069

Lane

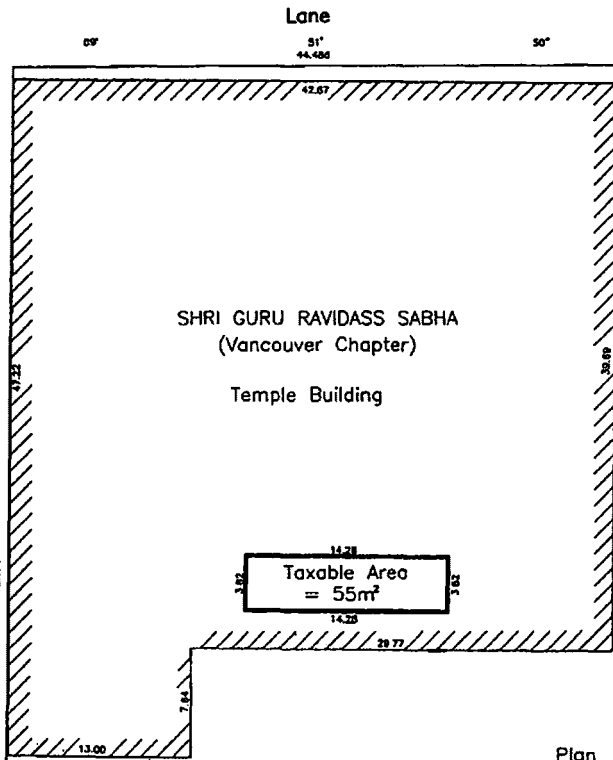
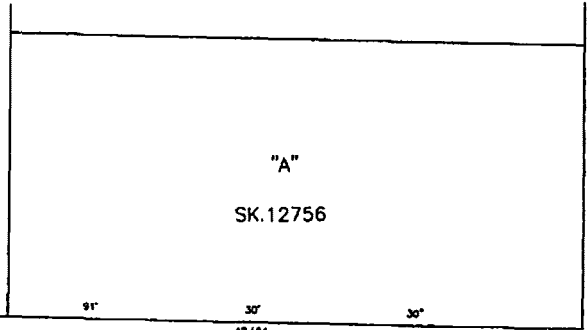

SHRI GURU RAVIDASS SABHA
 (Vancouver Chapter)

Temple Building

Taxable Area
 = 55m²

Taxable Parking
 Area = 52 stalls * 17m²
 = 884m²

Total Taxable
 Area = 55m²
 + 884m²
 939m²

Total Lot Area
 = 6222m²

Plan
 51
 34615

AVE.

RANDOLPH

AVE.

GILLEY

BERESFORD ST.

The City of Burnaby

City Clerk

Certified correct this 4th day
 of Sept. 2008.

B.C.L.S.