

**CITY OF BURNABY**

**BYLAW NO. 12497**

A BYLAW to amend Bylaw No. 4742, being  
Burnaby Zoning Bylaw 1965

WHEREAS application for rezoning has been made to the Council;

AND WHEREAS the Council has held a public hearing thereon after duly giving notice of the time and place of such hearing as prescribed by Sections 892 and 893 of the *Local Government Act*, R.S.B.C. 1996;

NOW THEREFORE the Council of the City of Burnaby ENACTS as follows:

1. This Bylaw may be cited as **BURNABY ZONING BYLAW 1965, AMENDMENT BYLAW NO. 46, 2008.**
2. The Map (hereinafter called "Map 'A'"), attached to and forming an integral part of Bylaw No. 4742, being "Burnaby Zoning Bylaw 1965", and designated as the Official Zoning Map of the City of Burnaby, is hereby amended according to the Map (hereinafter called "Map 'B'"), marginally numbered R.Z. 3702 annexed to this Bylaw, and in accordance with the explanatory legend, notations, references and boundaries designated, described, delimited and specified in particularity shown upon said Map 'B'; and the various boundaries and districts shown upon said Map 'B' respectively are an amendment of and in substitution for the respective districts, designated and marked on said Map 'A' insofar as the same are changed, modified or varied thereby, and the said Map 'A' shall be deemed to be and is hereby declared to be amended accordingly and the said Map 'B' is hereby declared to be and shall form an integral part of said Map 'A', as if originally incorporated therein and shall be interpreted accordingly.

3. The Comprehensive Development Plan entitled "REFLECTIONS –BURNABY, BC" prepared by BUTTJES ARCHITECTURE INC. and on file in the office of the Director Planning and Building, is deemed to be attached to and form part of this Bylaw and any development on the lands rezoned by this Bylaw shall be in conformity with the said Comprehensive Development Plan.

Read a first time this 21<sup>st</sup> day of July 2008

Read a second time this 8<sup>th</sup> day of September 2008

Read a third time 16<sup>th</sup> day of February 2009

Reconsidered and adopted this 1<sup>st</sup> day of March 2010

  
MAYOR

  
CLERK

**BYLAW NUMBER 12497 BEING A BYLAW TO AMEND BYLAW  
NUMBER 4742 BEING BURNABY ZONING BYLAW 1965**

**LEGAL:** See attached Schedule A

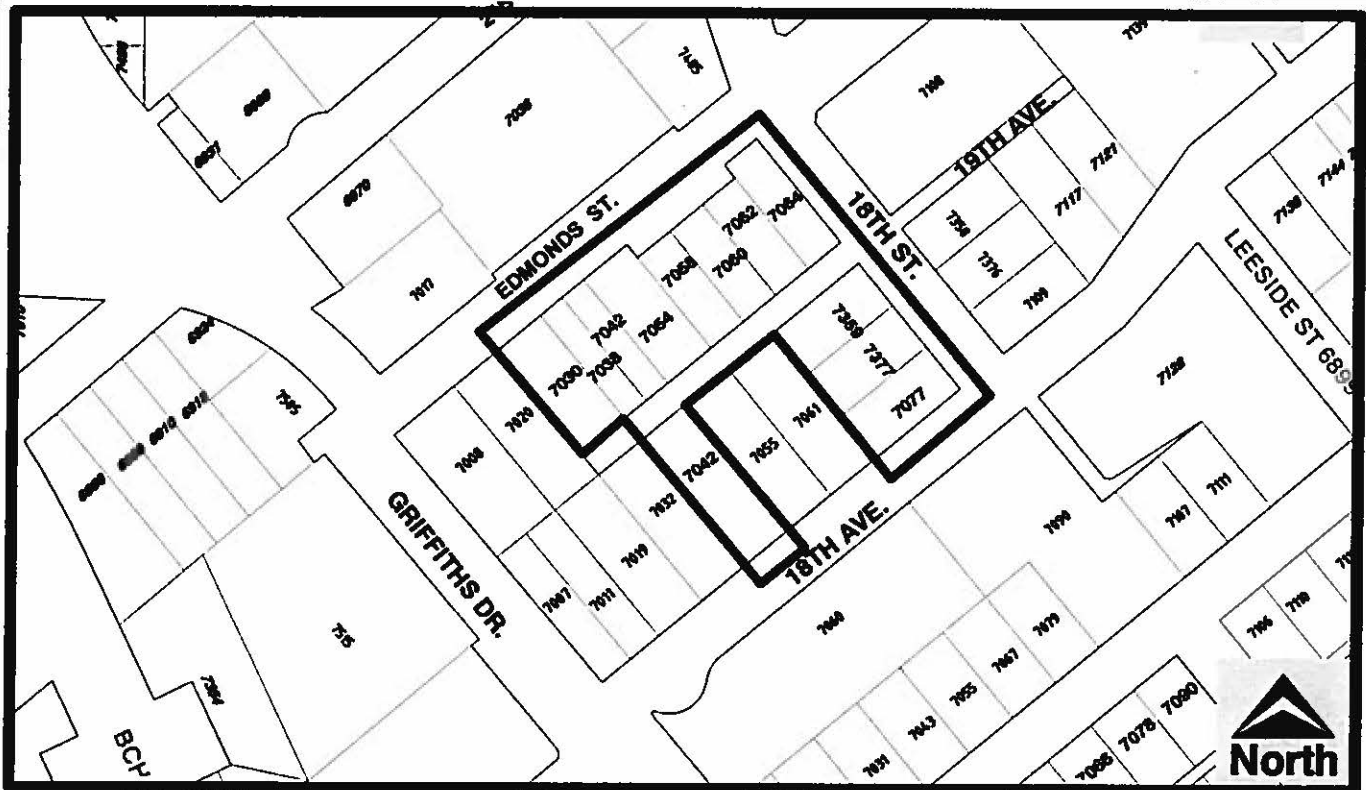

**THE AREA(S) SHOWN ABOVE OUTLINED IN BLACK (—) IS (ARE) REZONED**

**FROM:** R5 Residential District

**TO:** CD Comprehensive Development District (based on RM4 Multiple Family Residential District, P3 Park and Public Use District and the Edmonds Town Centre Plan as guidelines and in accordance with the development plan entitled "Reflections - Burnaby, BC" prepared by Buttjes Architecture Inc.)



**Planning and Building Department**

**Scale:** N.T.S.

**Drawn By:** J.P.C.

**Date:** July 2008

**OFFICIAL ZONING MAP**

**Map "B"**

**NO.REZ. 3702**

**Rezoning Reference #07-57  
Schedule A**

7030 Edmonds Street	Lot 3, Blk 2, DL 95, Group 1, NWD Plan 1981
7038 Edmonds Street	South Half Lot 4, DL 95, Group 1, having a frontage of 33 feet on Mara Road by full uniform depth of said lot and adjoining Lot 3, NWD Plan 1981
7042 Edmonds Street	Parcel A (BY29120E) of Lot 4, DL 95, Group 1, NWD Plan 1981
7054 Edmonds Street	Lot 5, DL 95, Group 1, NWD Plan 1981
7058 Edmonds Street	Lot 160, DL 95, Group 1, NWD Plan 29427
7060 Edmonds Street	Lot 161, DL 95, Group 1, NWD Plan 29427
7062 Edmonds Street	Lot 162, DL 95, Group 1, NWD Plan 29427
7064 Edmonds Street	Lot 163, DL 95, Group 1, NWD Plan 29427
7359 18 <sup>th</sup> Street	Lot 1, DL 95, Group 1, NWD Plan 2485
7377 18th Street	Lot 2, D.L. 95, Group 1, NWD Plan 2485
7077 18 <sup>th</sup> Avenue (7393 18th Street)	Strata Lots 1 and 2, DL 95, Group 1, NWD Strata Plan NW2340 together with an interest in the common property in proportion to the unit entitlement of the strata lot as shown on Form 1
7042 19 <sup>th</sup> Avenue	Lot 23, DL 95, Group 1, NWD Plan 1981
Portion of 19 <sup>th</sup> Avenue and Edmonds Street road allowances	